



**MODEL : KF-45**

# Healthy and Fresh!

## COLENT

**448-7674 / 442-3866 / 4149890**

**www.colentco.com / www.colent-iwata.com**



# OWNER'S MANUAL

**READ AND SAVE THESE INSTRUCTIONS**

Correct Disposal of this product	
	<p>This marking indicates that this product should not be disposed of as waste throughout the EU.</p> <p>To prevent possible harm to the environment or human health from uncontrolled waste disposal, recycle it responsibly to promote the sustainable reuse of material resources. To return your used device please use the return and collection systems or contact the retailer where the product was purchased.</p> <p>They can take this product for environmental safe recycling.</p>

The product has a worldwide patent, no reproductions allowed.  
 We reserve the right to pursue legal actions against any unit or individual who may reprint  
 All rights reserved for changing the design of products  
 If anything changes, we may not be able to keep you informed as soon as possible.  
 Sorry for any inconvenience.

Read all instruction carefully before setting up and operating this unit.  
 This manual is designed to provide you with important information needed to  
 setup, operate, maintain and troubleshoot your cooler.  
 Due to continuous research and development the specifications herein are subject  
 to change without prior notice.



## Table of Contents

1.PRODUCT FEATURES.....	2
2.TECHNICAL PARAMETERS.....	2
3.SPARE PARTS LIST.....	3
4.CONSTRUCTION DIAGRAM.....	3
5.OPERATION INSRUCTION.....	5
6.CONTROL PANEL AND OPERATION.....	5
7.IMPORTANT SAFEGUARDS.....	7
8.MAINTENANCE AND CLEANING.....	8
9.CIRCUIT DIAGRAM.....	9
10.TROUBLESHOOTING.....	9



## 1.PRODUCT FEATURES

- ◆ **Cool**  
It circulates water to blow cool air.It can lower the surrounding temperature and provide you with a comfortable environment especially on hot summer days.
- ◆ **Humidifier**  
It humidifies the air to avoid dry skin.
- ◆ **Ionizer**  
It releases negative ions to freshen the air and keep you healthy
- ◆ **Drawer style water tank,detachable filtration mesh**  
It is easy to clean.Filters remove tiny and harmful substances like dust and pollen
- ◆ **Energy saving,high-efficiency,environment-friendly**  
The input power is 180W
- ◆ **Wide range of air output**  
100 degrees angle wide range of air output.3 fan speed: HIGH-MID-LOW
- ◆ **Remote Control**  
12 meters remote control operating distance and 120 degrees angle wide range receiver.
- ◆ **“Beep” sound reminder**  
It has beep sound reminder function,convenient to use.
- ◆ **Water shortage reminder**  
It will show water shortage sign on the screen to remind you to add water
- ◆ **Memory function**  
It can memorize the current working status until the unit is turned off
- ◆ **High grade computer control system**  
0.5 to 12 hours timer setting

## 2.TECHNICAL PARAMETERS

Model	KF-45
Rated Voltage	220~240V
Rated Frequency	60Hz
Input Power	180W
Running Current	0.8A
MAX Air Flow Consumption	3500m <sup>3</sup> /h
MAX Water Volume	45L
Net Weight	28 KG
Measurements	550×408×1665mm

## Healthy and Fresh!

**Note:** Due to constant development of our products in regards to specification and design, we take reservation for change without prior notice.

The running range of the air cooler:

The ambient temperature range: 10 - 45°C

The pressure of water: 0.2MPa - 0.6MPa

### 3.SPARE PARTS LIST

No.	Designation	Quantity (pcs)
1	Remote controller	1
2	Instruction manual	1

### 4.TECHNICAL PARAMETERS

No.	Designation	Quantity (pcs)	No.	Designation	Quantity (pcs)
1	Protective net	1	22	Front cover (down)	1
2	Cellulose pad	1	23	Fixed link (down)	1
3	Bracket of motor	1	24	Left side cover	1
4	Motor	1	25	Fixed link of water tank	1
5	Fan blade	1	26	Base	1
6	Water distributor	1	27	Castor	1
7	Top lid	1	28	Flow deflector	1
8	Right side cover	1	29	Auto filter	1
9	Fixed link (up)	1	30	Water tank	1
10	Mesh platen	1	31	Back side cover	1
11	Mesh	1	32	Rubber stopper	1
12	Front cover (up)	1	33	Water lever probe	1
13	Air diffuser	1	34	Transformer	1
14	Pcb	1	35	Water pump	1
15	Control box	1	36	Floater	1
16	Bracket of swing motor	1	37	Drain pipe	1
17	Biot	1	38	Remote control	1
18	Swing motor	1	39	Pipe	1
19	Screw	1	40	Inlet valve	1
20	Nut	1	41	Flow deflector	1
21	Ionizer	1			

 iwata

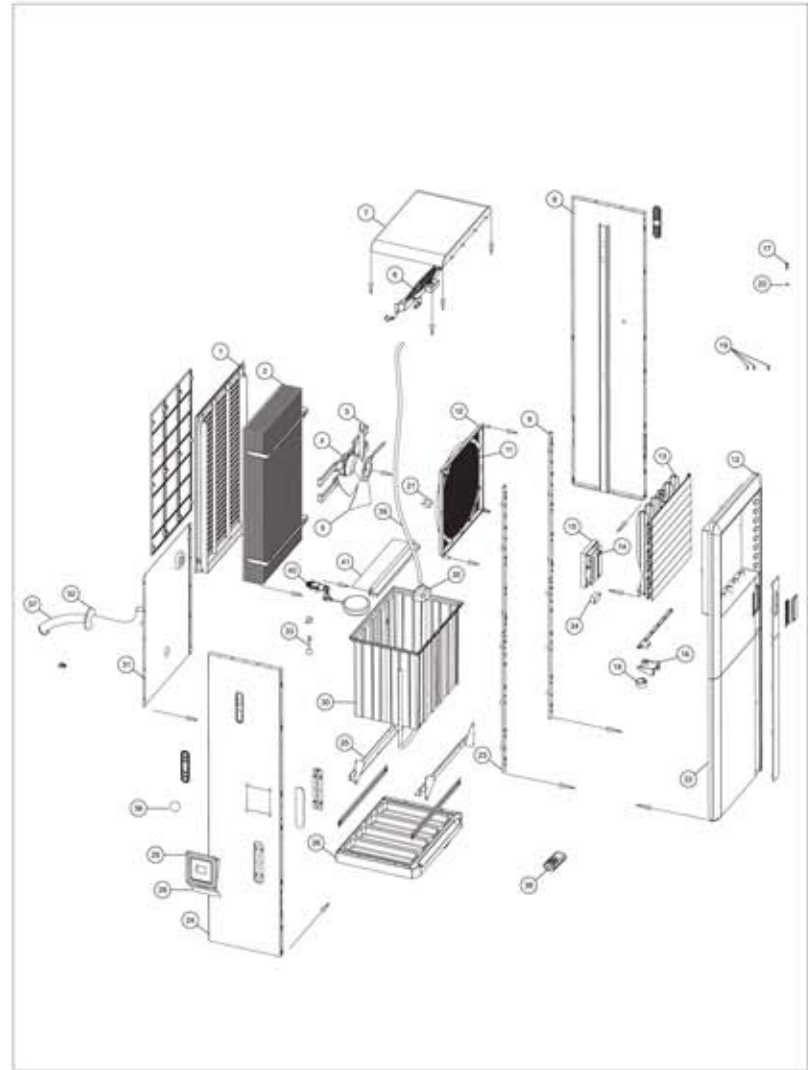

**Healthy and Fresh!**

## 5. OPERATION INSTRUCTION

1. Pull the unit out from the carton and place it on the floor
2. Check if the spare parts are complete as per the spare parts list
3. Only use the unit with the correct power requirement
4. Connect to the hose on the back to fill with water (PIC1) or on the side of the unit.

### Note:

- (1) Water level must be between the MIN and MAX line (shown as PIC3)
- (2) After a few days of operation, dust and dirt may accumulate in the water tank. It is recommended to change water and clean the water tank frequently.
- (3) Water shortage warning. When water is lower than Min. Level you will hear a "Beep" sound, it will show water shortage sign on the screen, the sign will disappear after water is added.
- (4) When water shortage warning sounds for 10 seconds but no water is added, the pump will automatically stop working.
5. Only use the unit with correct power requirement. Plug the unit and switch the power on and a "Beep" sound can be heard and the power light will be on at the side of the unit



PIC 1



PIC 3

### Remarks:

- (1) To protect against electric shock, do not remove the plug from the wall outlet with wet hands.
- (2) Unplug from outlet when moving the unit.

### 7. Remote Control

- (1) Install 2 AAA batteries in the remote control
- (2) The function of the remote control is the same with the control panel.

### Note:

1. Do not mix old and new batteries.
2. Remove the batteries from the remote control when it is not going to be used for a long period of time.

## 6. CONTROL PANEL AND OPERATION

**ON/OFF:** Press this button once to activate the unit. It will start functioning under previous status. If using for the first time it will start up on LOW speed and press this button again to turn OFF.

**SPEED:** Press this button to select desired fan speed LOW-MID-HIGH-LOW in this order. The corresponding air flow speed light will be displayed.

**COOL:** Press this button once to start the evaporative cooling function, press this button again to cancel.

5



**MODE:** Press this button to select the desired wind mode, NORMAL-NATURE-SLEEP-HUMIDIFY-NORMAL, in this order. The corresponding wind mode indicator will be displayed.

(1) Normal: It works as per the selected fan speed (HIGH, MID, LOW)

(2) NATURE: It works as per the pre-set program, imitating the natural wind, choose from LOW, MID, HIGH speed based on your preference.

(3) SLEEP: Fan speed alternates randomly

1. If ON HIGH, the unit will work under HIGH wind mode for another half an hour, then down to MID wind mode for another half an hour and then to LOW WIND mode.

2. If ON MID, the unit will work under MID wind mode for half an hour, then DOWN to LOW wind mode afterwards.

3. If ON LOW, the unit will work under LOW wind mode all Throughout

**IONIZER:** Press this button once to release negative ions into the air to freshen the air. Press this button once again to cancel.

**SWING:** Press this button once to make horizontal swing of vertical louvers. The SWING sign will be displayed. Press again for fixed air direction. You may adjust the horizontal louvers manually.

**TIMER:** It can be set between 0.5 to 12 hours, intervals. It is set at 12 hours when all of the 4 timer lights are on. Press this button again to cancel.

**LIGHT:** Press this button to open the light of the LCD screen, press again this button again to cancel.

(Remote control panel has the same function as the units control panel.)



6

**Healthy and Fresh!**

## 7. IMPORTANT SAFEGUARDS

1. READ ALL INSTRUCTIONS BEFORE USING.
2. DO NOT open and repair the unit by yourself
3. To protect against electric shock, keep the unit dry. Do not operate with wet hand
4. Unplug the unit from the outlet while filling with water, before cleaning, with maintaining or when moving the unit
5. Unplug power cord from the outlet when not in use
6. Do not insert any other objects into the air window during operation
7. Do not cover the unit with paper, cardboard, plastic, metal foil, or any other flammable materials when in use. Otherwise fire may occur. Keep the unit away from any hot sources.
8. Place the unit firmly on the ground.
9. Do not use outdoors.
10. Water level must be between the MIN and MAX line to activate cooling function
11. After filling with water, do not tilt the unit or move it as it may cause water to overflow from the sides of the tank. If the unit needs to be moved a little, push it on the sides gently.
12. Never put the unit upside down after filling water.
13. Do not place any objects on top of the unit
14. Do not use petrol to clean the body. For slight dirt on the body, wipe it off with a soft damp cloth. For greasy dirt, squeeze a little toothpaste or mild detergent on a soft damp cloth and then wipe the dirt off
15. Do not strike or shake the unit's body during operation. Otherwise, it will stop working automatically. In this case restart the unit.
16. After a few days of operation dust and dirt may settle in the water tank. It is recommended to change the water and clean water tank frequently.
17. Empty the water tank when not in use to prevent any unpleasant odor
18. Do not use the unit for purposes other than its intended use.
19. Do not use the unit when the power cord is damaged. Send to service center for repair. If the supply cord is damaged, it must be replaced by a special cord or assembly available from the manufacturer or its service agent.
20. Keep children away from the air flow window while in use.
21. Keep cord away from sharp or hot objects
22. Do not clean with metal scrubbing pads. It may scratch the surface or cause electrical shock.
23. Do not use if the unit malfunctions. Send to service center to repair.



24. Do not clean the unit with flammable liquid
25. Avoid sharing a power outlet with any other appliances
26. Do not mix new and old batteries on the remote control
27. Take off batteries from remote control when not to be used for a long period time
28. This product is not intended to be used by person with physical disabilities unless supervised by responsible adults.
29. Ensure that children do not play or touch the grilles of this product.
30. Do not cover the air window when machine is running.
31. The appliance must be fitted with means for disconnection from the supply mains having a contact separation in all poles that provide full disconnection under/over voltage category III conditions, and these means must be incorporated in the fixed wiring in accordance with the wiring rules.
32. Please make sure that the unit and power connection have good earthing, otherwise it may cause electrical shock.

## 8. MAINTENANCE AND CLEANING

### Note:

After some time of operation, the filtration mesh becomes clogged with dust and dirt, which will greatly affect the unit's performance. It is recommended to clean the filtration mesh frequently.

### Cleaning the filtration mesh

1. Remove plug from the power source
2. Loosen screw and hold the filtration mesh handle and pull upwards
3. Clean the filtration mesh with mild detergent and soft brush with water.
4. Make sure the filtration mesh is completely dry before installing back.

### Cleaning the water tank

1. Remove plug from the power source.
2. Pull out the water tank
3. Clean the water tank with a mild detergent with sponge /cloth and then rinse with water
4. Put the water tank back in place

### Cleaning the Body

Cleaning the body with mild detergent using a soft sponge/cloth

### Note:

**Unplug from outlet before cleaning**

**Do not pour water on the control panel or it may damage the unit.**

**Healthy and Fresh!**

## 9. CIRCUIT DIAGRAM

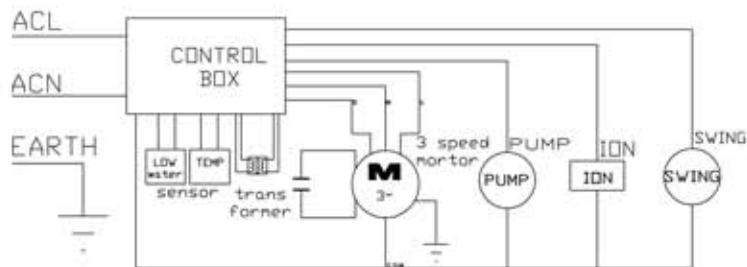

The specification of fuse AC250V, 3A, 5x20mm, T,L

## 10. TROUBLESHOOTING

If there is something wrong during operation, it may not be the unit's problem. You may check against the list before sending for repair:

Symptom	Possible reasons	Solutions
Cooler not working	<ol style="list-style-type: none"> <li>1. The plug is not securely inserted into the socket or not connected well</li> <li>2. The "ON/OFF" button is not pressed</li> </ol>	<ol style="list-style-type: none"> <li>1. Insert the plug pin into the wall socket and make sure it is connected well.</li> <li>2. The "ON/OFF" button after plugged.</li> </ol>
remote control not working	<ol style="list-style-type: none"> <li>1. Wrong polarity of the batteries or poor contact</li> <li>2. Battery Exhausted.</li> </ol>	<ol style="list-style-type: none"> <li>1. Adjust the polarity of the batteries to the correct position</li> <li>2. Change new batteries.</li> </ol>
Dust filtering effect not good	<ol style="list-style-type: none"> <li>1. The filtration mesh is clogged with dust and dirt, which affects the units performance</li> <li>2. The air vent is obstructed</li> </ol>	<ol style="list-style-type: none"> <li>1. Clean the filtration mesh.</li> <li>2. remove the foreign objects from the air vent</li> </ol>

**Notice:**

1. If the problem cannot be found in the list or it persists, please contact our service center or a qualified technician for further inspection.
2. Do **NOT** open and repair the unit by yourself.