

 iwata

MODEL : AIRBLASTER-13R

Health and fresh!

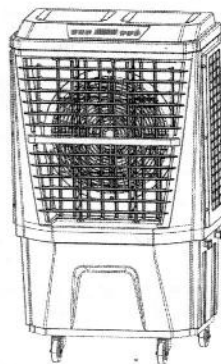

## OWNER'S MANUAL

READ AND SAVE THESE INSTRUCTIONS

CORRECT DISPOSAL OF THIS PRODUCT	
	<p>This marking indicates that this product should not be disposed with other household wastes.</p> <p>To prevent possible harm to the environment or human health from uncontrolled waste disposal, recycle it responsibly to promote the sustainable reuse of material resources.</p> <p>To return your used device, please use the return and collection systems or contact the retailer where the product was purchased.</p> <p>They can take this product for environmental safe recycling.</p>

*The product has applied for the patent, anyone who copies will be investigated into law responsibility!  
Tell the world: All copyright reserved,  
we preserve the right to pursue legal actions against any unit or individual who may reprint.  
All rights reserved for changing the design of products,  
If anything changes, we may not keep you informed as soon as possible. Sorry for any inconvenience.*

For after-sales service:  
Landline-6327442-3866; 412-6155; 413-8819; 442-3856; 448-7674  
Mobile-0923-5345681; 0917-3079188; 0920-9746874  
Email at: sales\_mk1g@colentco.com; iwata@colentco.com; iwata2@colentco.com or iwata3@colentco.com  
Website: WWW.COLENTCO.COM

- Read instructions carefully before setting up and operating this unit.
- This manual is designed to provide you with important information needed to setup, operate, maintain, and troubleshoot your cooler.
- Due to continuous research and development the specifications herein are subject to change without notice.



## Health and safety

### 1. FOREWORD

Thank you for your trust and support for choosing our Evaporative Air Cooler!  
Please read this manual carefully before use.

The Evaporative Air Cooler comes with the Most Advanced evaporative cooling technology and the Modern management. It will make your life easier and more comfortable.

### 2. PRINCIPLE OF WORK

Evaporative coolers lower the temperature of air using the principle of evaporative cooling. It's the natural way of way of cooling, similar to a breeze blowing across a lake. This breeze drops the temperature and has a relaxing cooling effect. The evaporative air cooler cools the air by means of the evaporation of water. When water evaporates into the air, the result is a mixture of air and water molecules. This chemical change requires heat which is taken from the water molecules, resulting in cooler air propelled from the unit.

### 3. CAUTION

This appliance is not intended for use by persons (including children) with reduced physical, sensory or mental capabilities, or lack of experience and knowledge, unless they have been given supervision or instruction concerning use of the appliance by a person responsible for their safety.

Children should be supervised to ensure that they do not play with the appliance.

If the supply cord is damaged, it must be replaced by the manufacturer, its service agent or similarly qualified persons in order to avoid a hazard.

Ensure that the fan is switched off from the supply mains before removing the guard.

Unplug the appliance during filling and cleaning.

### 4. ATTENTION

1. The temperature decrease will be greater in drier climates because higher evaporation occurs when the humidity is low.
2. The evaporative air cooler should not be used in enclosed spaces. It must be kept level and there must be water in the water tank. Enough air exhaust is a Must to run the cooler. (3000m<sup>3</sup>/h airflow requires up to 0.8m<sup>2</sup> of exhaust area when natural exhausting and the exhaust capacity should not less than 85% of airflow when mechanical exhausting.) Mechanical can be combined with the natural exhaust. The evaporative air cooler works best when placed near an open window, so that outside air is drawn into the evaporative air cooler.
3. Debugging the cooler when the first running. Ensure that the operating current at the rated current range.
4. Ensure the supply voltage is within the rated  $\pm 10\%$  range, otherwise it will break the cooler such as cannot start the cooler or start and stop frequently.

5. Please power OFF the cooler while it is running or thundering.

6. The appliance must be fitted with means for disconnection from the supply mains having a contact separation in all poles that provide full disconnection under over voltage category III conditions, and these means must be incorporated in the fixed wiring in accordance with the wiring rules.

7. Please make sure that the unit and power connection have good earthing, otherwise may cause electrical shock.

8. When the product is used for the first time the cooling pad media will have an odour which will dissipate in a week or so of initial use.

9. Always unplug the appliance from the power source before cleaning, servicing.

### 5. INSPECTION AND PREPARATION BEFORE ASSEMBLING

1. Please open the side panel to check the parts and the technical parameters (the manual), if the parts are incomplete or breakage. Leave it as it is and inform us or the distributor.

2. Check if the supply voltage is same as the rated one and the supply frequency same as rated one. Make the voltage is 230±10V.

3. Make sure the water is clean with a steady hydraulic pressure, 0.2-0.6MPa (1.5-6kgf/cm<sup>2</sup>).

4. A globe valve is needed near the intake hose, and an extra hose connector is needed for cleaning.

5. Over-current and leakage protection switch should be added on the feed circuit, to protect the cooler, the wire net, and the safety of people.

### 6. GUIDE FOR INSTALLATION AND UNINSTALL OF SIDE PANEL

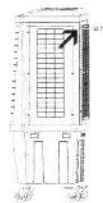

figure 1

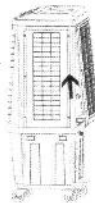

figure 2

1. Loosen 6 screws with Philips screwdriver, as figure 1.
2. Pull the side panel and take it out, as figure 2.
3. Preise install as the contrary steps as above.

Health and fresh!

## 7. GUIDE FOR FILLING WATER AND DRAIN

Water can be filled into the air cooler by

Continuous water supply

Connect a garden hose to the continuous water supply inlet.

Water can be pour into the unit from hole as figure 3;

Drain:

Open the valve cover wither shins, also close it clockwise after drain, as figure 4.

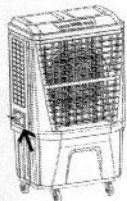

figure 3

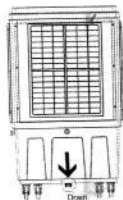
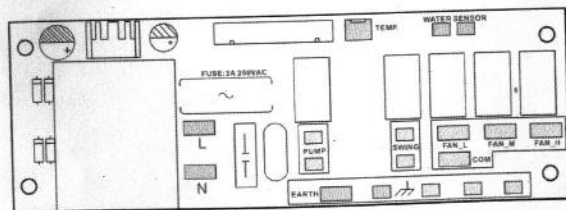

figure 4

## 8. CIRCUIT DRAWINGS



③

## 9. INSPECTION AND DEBUGGING

1. Place the unit on the level floor when assemble cooler.
2. Check if drain pipe has been assembled.
3. Check the water supply to be sure there is no leakage.
4. Debug the water level in the water tank.
5. Check if the power supply connection is correct.
6. Check if the assembling and connection of the power control.
7. Check if there is litter in the water tank.
9. Check if the power supply and the voltage is in the rated range.
10. Check if the running electrical current is in the rated range.
11. Check if there is any vibration when running the cooler.

## 10. GUIDE FOR OPERATION

Introduction of the control panel

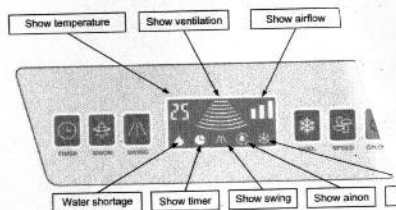

Introduction of the function of the button on the remote controller

1. ON/OFF: Start the cooler in stand-by state or stop.
2. SPEED: Change the airflow for the conversion from low speed, mid speed and high speed, the rank is 1-2-3-1.
3. COOL: Switch to cool mode.
4. Reserved.
5. SWING: Start or stop swing.
6. TIMER: Start timing function.
7. Anion

100-017

## Health and fresh!

### Operating Introduction

Please ensure the power cords are connected correctly before use!

#### 1) ON/OFF

Press this button will start the unit. The mode and the airflow will be the same as the last state when you power off it. The speed is at speed 2 and the cool function is ON when you power it at first time. The airflow will be showed at the range of L, M, H from left to right dynamically.

Press this button while the cooler is operating, it will stop and only the temperature will be showed on it.

#### 2) Airflow regulation

Press "SPEED" button on the control panel or "SPEED" on the remote controller to regulate the fan speed. It can be changed from L-M-H-L-M-H... and that will be showed on the "airflow indicator".

#### 3) Mode

Press "COOL" button on the control panel, the mode will be changed by COOL-VENTILATION-COOL...

When the cooler is start or operating, switch to COOL mode, it will run at the lowest speed for 30s and then switch back to the initial speed. The process of speed-change will not show on the LED screen.

#### 4) SWING

The "SWING" button will be lighted on when pressing the "swing" button on the control panel or remote controller.

#### 5) TIMER

"Timer" set to start or stop the air cooler automatically after N hours later. It is set by the hour. It will start the air cooler automatically in the stand-by state and stop it automatically when it is running during the time is arrived.

"H x" ("x" means the time you set) will be showed on the temperature indicator during the time is setting, and the temperature will be showed again on it after the timer takes effective.

The "TIMER" will be flickering when pressing the button and you can change the time by pressing the "AIRFLOW". 9 hours is the maximum.

The timer will be working automatically after 5 seconds when you finish setting and the "TIMER" will be lasting lighted on.

#### How to cancel the time set:

- Set the time 00.
- Press the "ON/OFF" button when the "TIMER" flickering during setting.
- Press the "ON/OFF" button after the timer takes effective.

## 11. CLEAN AND MAINTAINING

Always unplug the cooler before cleaning.

- Cabinet Cleaning: please clean with mild cleaner and the soft cloth. Evaporable liquor such as gas or alcohol is NOT allowed.
- Cooling pad cleaning: take out the pad and brush the dust on its surface with SOFT brusher.
- Water tank cleaning: Set the time and frequency according to manual when automatically cleaned. Take out the plug of drainage outlet and clean it when manual cleaned.
- Maintenance:
  - The frequency for cleaning depends on the local air and water conditions. For example, in areas where mineral content of the water is high, deposits may build up in the cooling pad, restricting air flow. In this case, it is recommended to clean the cooling pad every two months.
  - Always drain the water from the unit after use.
  - For best results, allow the cooling pad to dry after each use by turning off the cool function 15 minutes before turning the unit off.
  - Before store an evaporative air cooler, please power off, drain all the water and add the dust filter to avoid the dust and the mosquito breeding.

## 12. TROUBLE SHOOTING

NO.	Problem	Reason	Solution
1	No discharge of air	Power off or incorrect power connection	Make sure cord is plugged in and try to turn the unit on by pressing buttons on control panel or remote control.
		Controller breakdown	Replace it
		Fuse burnt	Replace it
		Electrical mainboard is broken	Replace it
2	No cooling	Pump is not turned on	Turn on cool function
		Damage pump	Replace pump
		No water / low water	Refill water
		The cool key on the controller is broken	Replace the controller
3	No airflow	Electrical mainboard is broken	Replace it
		The key on the control is broken	Replace the controller
4	Unpleasant odour	The motor is broken	Replace it
		Dirty water	Drain and refill fresh water
		Dirty cooling pad	Clean it

#### Notice:

- The above is only for your reference, if the problems can not be found in the table, please contact us or a qualified technician for further inspection.
- Do NOT open and repair the unit by yourself.

## 13. TECHNICAL PARAMETERS

MAX Airflow(m <sup>3</sup> /h)	4500	Fan Type	Axial
Power (W)	165	Speed	3
Voltage/Frequency (V/Hz)	220-240/50	Noise (dBA)	≤61
Rated Currenty (A)	0.75	Net Weight(kg)	22
Water Store(L)	40	Overall Dimension(mm)	700×455×1180