

*cardboard, perforated, can easily be taken out

Warranty Card

Register your IWATA by filling out this Warranty Card.

Warranty for IWATA Air and Room Cleaning System will be accepted if invoice is presented and if purchased through authorized *Distributors* with the signed, recorded, and filed Warranty Card as proofs of purchase.

Name _____
Address _____
Mobile _____
Telephone _____
E-mail _____
Authorized Dealer _____
Model Code/Serial No. _____

WWW.COLENTCO.COM

448-7674/414-9890

**IWATA CM-123M
WATER FILTRATION
VACUUM CLEANER**

IWATA CM-123M WATER FILTRATION VACUUM CLEANER

The IWATA Air and Room Cleaning System utilizes WATER FILTRATION technology to clean air and sanitize your home. No messy bags, it uses just pure water to filter all unwanted dust and dirt.

***Actual Picture of Unit

Applications:

- High powered wet & dry vacuuming for domestic & commercial uses
- Deep cleaning with specialized add-on brushes
- Wet & dry cleaning of hard floors
- Wet & dry cleaning of carpeted floors and upholstery
- Cleans, filters & Ionizes the air

Specifications:

- Power: 1000 Watts
- Suction Power: 150 Watts
- Air Pressure: 15.5 Kpa
- Water pan capacity: 2 liters

MULTI-PURPOSE AIR AND ROOM CLEANING SYSTEM

Replace inefficient brooms, mops, feather dusters, and vacuum cleaners with the multi-purpose IWATA! It absorbs both wet and dry dirt simultaneously. IWATA sweeps floors, walls, and ceilings efficiently and effectively. Along with that, you can also use the Air and Room Cleaning system to clean all your upholstery, door screens, and carpets. It cleans and sanitizes everything that you can find in your house or office spaces. A convenient all-in-one high powered cleaning system.

POWERFUL CLEANER and SANITIZING SYSTEM

While operating the IWATA, all surrounding dust, dirt, allergens, and various air bacteria get trapped in water. Unlike ordinary wet/dry vacuums, dust escapes the filter bag when it is to be emptied; thus, releasing the polluted air molecules in the air again. IWATA Air and Room Cleaning System effectively cleans the surrounding air while at the same time releasing powerful negative ions in the surrounding areas to keep dust mites and various airborne bacteria particles away.

HEALTH

It sanitizes indoor air by trapping pollens, insect eggs, and dust mites and killing airborne bacteria that are harmful to every person's health. Clean air is just as important as the water that we take in. Suspended air particles can cause asthma and allergies that irritate and weaken our respiratory system which can eventually lead to more serious diseases. With the IWATA Air and Room Cleaning System you can be sure that your living and working areas remain safe for those dearest to you.

EFFICIENT POWER

When too much dust is trapped in ordinary wet/dry vacuums, the filter bag gets easily blocked and reduces its suction power into half. With IWATA, all the dirt and dust is trapped into water. It does not block the suction power; therefore, IWATA can be kept at 100% efficiency most of the time allowing you to save on electricity and maximize suction power.

AIR IONIZER & AIR FRESHENER

When air is suctioned into the IWATA, it is filtered inside the moving water and what comes out is ionized air that is clean and fresh. These ions help eliminate odour and keep air fresh. Have your own vaporizer by putting in aroma oil and freshen your home with relaxing and calming scents.

ECO-FRIENDLY

The IWATA uses natural water to clean and sanitize. The water is then safe to dispose off and won't release any harmful or toxic materials in the environment. Moreover it saves you money in the long run, because there's no need to replace the filter bags. With the ability to clean so effectively without generating waste, the IWATA Air and Room Cleaning System is the smart way to go in making your area clean and healthy.

Important Safety Instructions

When using electrical appliances it's crucial that all precautions be followed for safety and the longevity of your machine:

Please read ALL instructions before operating the IWATA Air & Room Cleaning system.

WARNING!

To decrease chances of fire, electric shock, or injuries:

- Never leave appliance plugged in when not in use. Unplug after every use and store in a wet safe place.
 - Use indoors only or in dry places.
 - Keep away from children and do not use as a toy. Pay close attention when using around children.
 - Follow directions outlined in this instruction manual. Use manufacturer's recommended accessories ONLY.
 - Discontinue use if cord or plug is damaged or severed. If appliance is not functioning properly or has been dropped, left outdoors, or dropped into water, immediately return to the distributor for inspection.
 - Never pull or carry by cord, use cord as a handle, close a door on cord and be careful around sharp edges or corners. Never run appliance over cord. Never step on the cord and keep cord away from heated rooms.
 - Do not unplug by pulling on cord. To unplug, grasp the plug, not the cord.
 - Do not handle plug or appliance with wet hands.
-

- Keep loose hair and clothing, hands & fingers, and all parts of body away from openings and moving parts to avoid injuries.
 - Turn off the unit before unplugging.
 - Use extra care when cleaning on stairs and uneven surfaces.
 - Do not use to pick up flammable or combustible liquids, such as gasoline, or use in areas where they may be present.
 - Do not pick up anything that is on fire, burning or smoking, such as cigarettes, matches, or hot ashes.
 - Do not use without water as filter in the water pan. Do not go beyond the water limit.
 - Always turn off this appliance before connecting or disconnecting accessories/add-ons.
 - Do not operate the unit without adult supervision.
-

Components

***Real Pictures

***Part by part, High Resolution

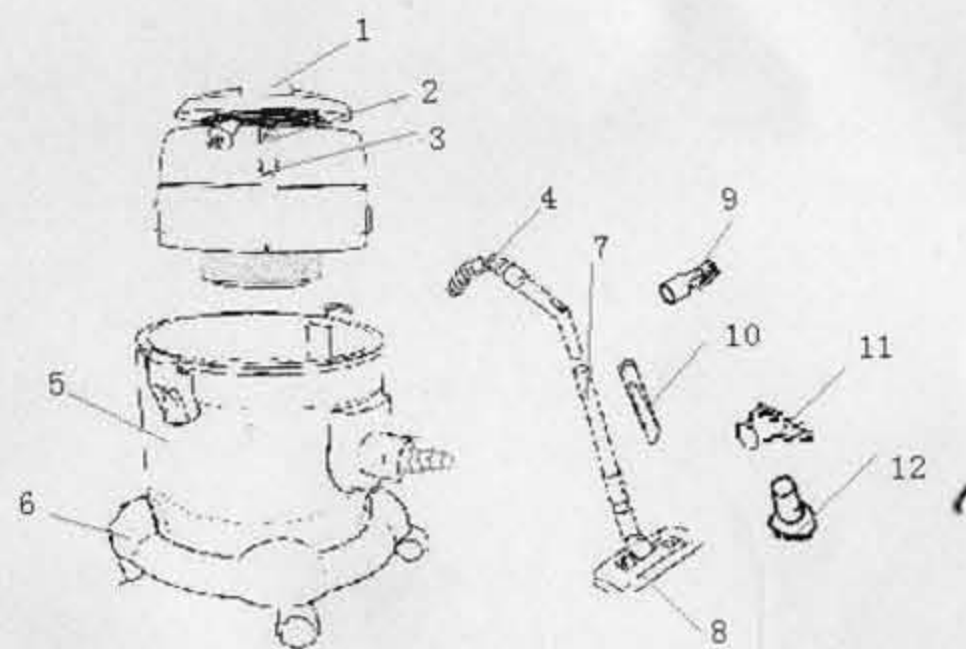

1. Motor Assembly
2. On/Off Button
3. Suction Power Control
4. Hose Assembly
5. Water Pan
6. Trolley
7. Tube
8. Floor Brush
9. Square Brush
10. Crevice Tool
11. Multi-Purpose Brush
12. Synthetic Bristle Brush

Accessories

Accessories	Purpose
Floor Brush	For daily use on carpets and hard floor
Crevice Nozzle	For in between gaps (such as corners)
Square Brush	For smaller areas
Multi-Purpose Brush	For furniture, sofa
Synthetic Bristle Brush	For uneven surfaces, soft objects, curtains, and upholstery

Preparation Before Use

***Actual Picture of Unit being used

1. Attach the tube to the hose assembly and then to the unit.
2. Attach the floor brush to the tube. Turn and secure them to a tight connection.
3. Fill up the water pan with 1.5 to 2 liters of water. It should not be above the marked water limit on the water pan.
4. Replace the floor brush with the appropriate accessory that you will use for cleaning.
5. Use caution during wet cleaning. Floor may get slippery.

Handling Instructions

***Actual Picture of Unit being used

1. Reel out the cord to an ideal length. Plug the unit to an electrical outlet.
2. Turn on the main switch.
3. The suction power control can be used to adjust suction power. When the slide button on the handle is opened, the blower power can be reduced.
4. Keep the space flat between floor brush and floor surface.
5. Hold the handle to clean – front and back, side to side, or up and down.

Instructions After Each Use

***Actual Picture of Unit being used

1. Turn off the main switch and disconnect the power cord from the power source.
2. Remove the Motor Assembly.
3. Take out the water separator.
4. Empty the water pan immediately after each use and rinse with clean water.
5. Store the unit properly in a secure place.

Warning!

- Disconnect the Power Cord from the power source before removing the Motor Assembly from the Water Pan!
- DO NOT use the system without water!
- This unit is not designed for vacuuming quantities of mineral dust!
- DO NOT vacuum flammable liquid like gasoline!