

### THE MEASUREMENTS OF WOOD FRAME

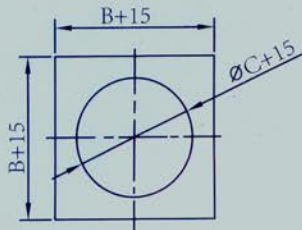

[www.colentco.com](http://www.colentco.com)

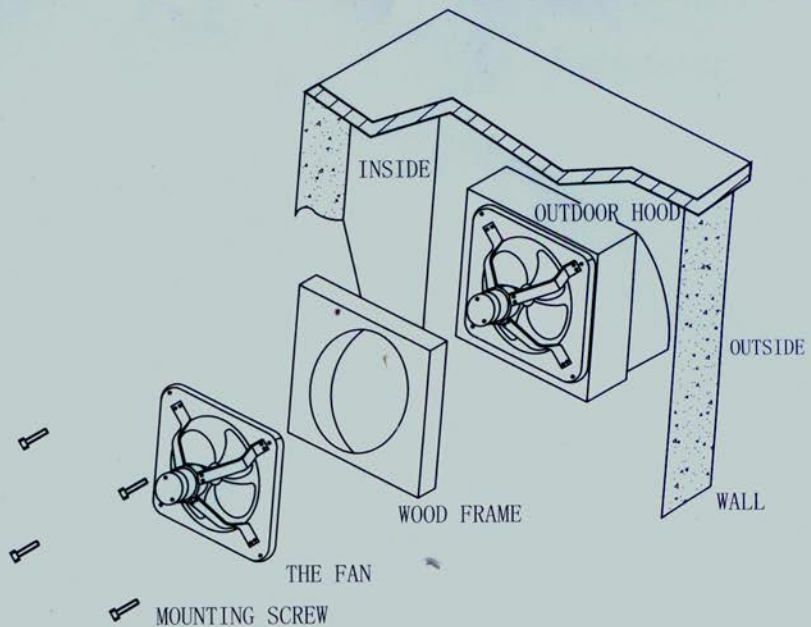

### INSTALLATION

1. The distance between ground and the fan is more than 2.3m.
2. Make a wooden frame, adjust support it into the wall.
3. Fit the fan into the wooden frame and secure with 4 screws.
4. When used in power supply, the socket should meet the IEC335-1 standard. When power supply is from the direct charging, a polarity switch should be installed with contact gap not less than 3mm on the charging line.
5. please install by professional person.
6. Type Y attachment - Damaged supply cords to be replaced by the manufacturer, service agent or similarly qualified person to avoid hazard.
7. Precaution must be taken to avoid the back-flow of gases into the room from the open flue of gas or other open-fire appliances.

### WIRING DIAGRAM

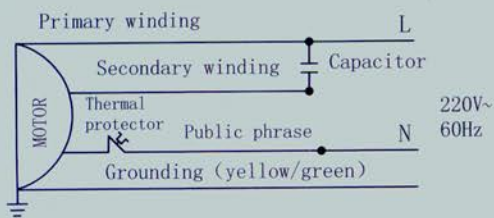

### IDENTIFICATION OF PARTS

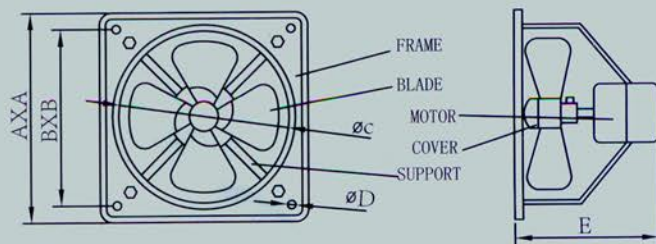

### Technical Parameter

Model	Voltage (V)	Frequency (Hz)	Power (W)	Speed (rpm)	Air volume (m <sup>3</sup> /h)	A	B	C	D	E
TORNADO EXF-G8	220	60	35	1600	780	230	197	200	12	125
TORNADO EXF-G10	220	60	40	1600	840	284	245	250	12	145
TORNADO EXF-G12	220	60	45	1600	1080	355	302	300	12	155
TORNADO EXF-G14	220	60	75	1600	2280	415	329	350	12	178
TORNADO EXF-G16	220	60	145	1600	2880	480	378	400	12	220
TORNADO EXF-G20	220	60	350	1600	5700	605	479	500	15	270
TORNADO EXF-G24	220	60	600	1600	8700	700	542	600	18	285

[www.colentco.com](http://www.colentco.com)