



Evaporative Air Cooler

Instruction manual

Model: CM14EC-A

Thank you for your purchase. Please read the instructions carefully before operating the unit and be sure to abide by the contents stated in the instruction manual. Please keep this manual for future reference.

Contents

I. Functions.....	2
II. Main Technical Parameters.....	3
III. Electrical Schematic Diagram.....	3
IV. Product Diagram.....	4
V. Security Rules	5
VI. Cleaning and Maintenance.....	6
VII. Usage of Ice pack.....	7
VIII. Troubleshooting and Maintenance.....	8

I. Functions

Note: the instruction describes all the functions. The users can choose them according to the actual product function.

On/off: when the unit is on standby, press the “on” button and low wind speed is set as default with the ionizer in working state; Press the “off” button, the fan stops working, and all lights go out and the fan is on standby.

Wind speed/shift: in the working state, wind speed can be regulated by pressing the button; if the button is pressed repeatedly, air supply mode can be chosen between three modes: high- medium-low.

Swing: in the working state, horizontal automatic swing function can be activated by pressing the button; but the swing function will be halted when the button is pressed once again.

Cooling: In the working state, pressing the button means start of the cooling function, and when pressing it again, the cooling function ceases.

Timer: in the working state, if the button is pressed, timer can be activated and if pressed repeatedly can be adjusted as follows:

→ 1hour→2hours→3hours up to 12 hours.

Natural wind: in the working state, the natural wind mode can be set by pressing the button. When pressing it again, the natural wind mode can be stopped while the wind speed will shift into low speed. (The wind speed is void in the natural wind mode)

Sleep button: In the working state, the sleep mode can be set by pressing the button. When pressing it again, the sleep mode can be ceased while the wind speed will shift into low speed.(The wind speed is void in the sleep mode)

Ionizer: In the working state, press the button and the ionizer will turn off; press the button again and the ionizer will turn on.

Water shortage protection: If water level is not sufficient, the pump will immediately stop, the buzzer turns on, light will turn on to signify water shortage.

Note: Unplug the unit before adding water.

Attention:

Keep the unit out of children’s reach. Always have an adult to supervise the children whenever they operate the unit.

Ensure that the power supply is disconnected when moving and cleaning the unit.

II. Main Technical Parameters

Model	CM14EC-A
Rated voltage	220V
Rated frequency	60Hz
Rated power	70W
Capacity of water	11L
Wind speed	6.4--7.8 m/s
Evaporation capacity	900mL/h
Energy efficiency	9.0W/W
Noise	≤65db
Type	Air cooler

III. Electrical Schematic Diagram

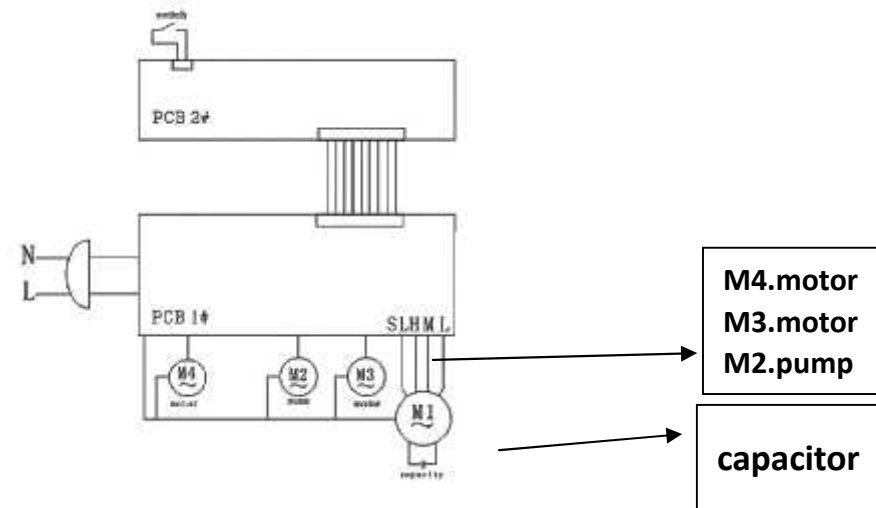

IV. Product Diagram

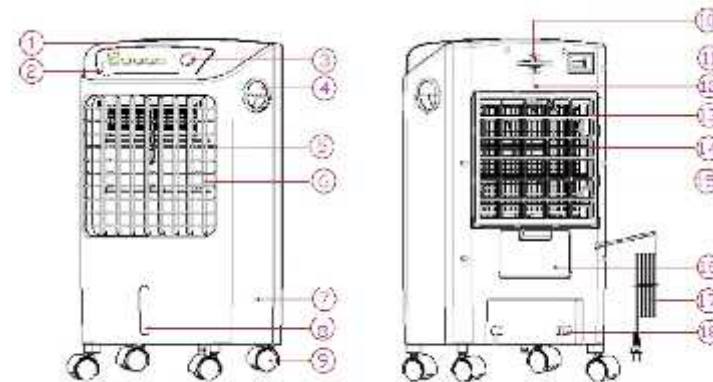

1. Cover
2. Buttons
3. Control panel
4. Handle
5. Vertical blades
6. Horizontal blades
7. Water tank
8. Water position indicator
9. Caster wheels
10. Remote control holder
11. On-off switch
12. Remote control
13. Air filter
14. Curtain holder
15. Curtain
16. Water ingress
17. Wire
18. Wire holder

V. Security Rules

1. Part-time workers and unauthorized repairmen are forbidden to repair or revise the unit's components as it will void the warranty.
2. Do not operate with wet hands to avoid electric shock.
3. If power lines are aging and knotted or the plug is damaged, they should be repaired by the authorized service center immediately.
4. Do not clean, maintain and move the air cooler when the power supply is connected.
5. Pull out the power plug when the air cooler is not going to be used for a period of time.
6. Do not insert foreign matter into the air inlet/outlet; otherwise, it will damage the air cooler.
7. Do not use the air cooler in an inflammable and explosive environment or direct sunlight.
8. Do not put the air cooler in an inclined or unbalanced position to avoid the air cooler from falling down, which can be detrimental to the air cooler or the components inside the unit.
9. When the water tank is full of water, do not lay the unit on its side or bump it with other objects when moving it. If you intend to move the air cooler, push it slowly and gently from the side. Please do not overfill with water.
10. Do not turn the unit upside down at anytime.
11. Do not cover the air outlet or inlet.
12. When cleaning the surface of the air cooler, use a damp cloth (detergent can be added) and do not use corrosive detergent or solution. Do not use water to rinse the motor or internal circuit boards.
13. Do not block the air inlet/outlet with the wall, curtain or other objects; otherwise, it will block the airflow, thereby affecting the air supply efficiency.
14. Please change the water supply regularly.

VI. Cleaning and Maintenance

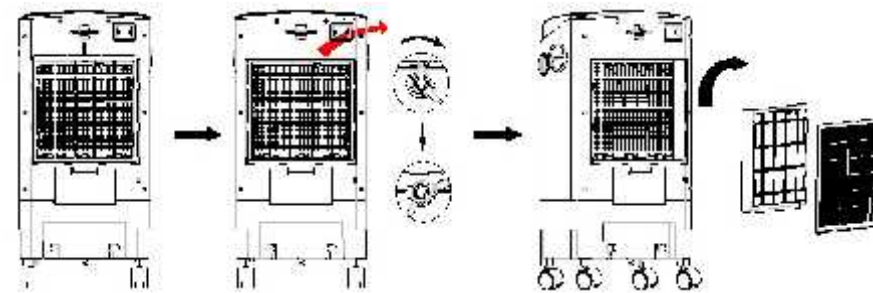

Reminder: Over a long period of running, the wind capacity and dust removing effects of the filter screen and cooling pad are going to deteriorate because of dust. So it is recommended to clean them regularly.

1. Cleaning the air filter

Cut off the power supply and unscrew the unit using a screwdriver and then the filter screen can be dismounted. Use mild detergent and brush to clean the filter and wash it with clean water, Make sure that the filter is completely dry before re-installing it to the unit.

2. Cleaning the cooling pad

Cut off the power supply and remove the air filter screen in order to take out the cooling pad from the back cover. Use a mild detergent and brush to clean the cooling pad, wash it with clean water and finally, dry it.

3. Cleaning the water tank

Cut off the power supply; take the air filter screen down, and then remove the water tank. Remove the dirt in the tank by using a wet towel with a mild detergent, After that, wash and rinse it with clean water, wipe it with a dry piece of cloth,

4. Cleaning the outer cover

Clean the outer cover with a mild detergent and a piece of soft cloth.

Attention:

-) Disconnect the power supply before cleaning the fan.
-) Control panel must not get wet.

VII. Usage of Ice packs

The ice pack has a special property of making the water cooler and can absorb the heat from water to keep the water temperature below the environmental temperature (8°C lower more or less) for several hours and make the air flow cooler.

- 1.** Ensure that the ice pack is filled with water, but no more than two-thirds full.
- 2.** Put the ice pack into the refrigerator and make sure it is frozen thoroughly.
- 3.** Put the ice pack into the water tank. Minutes later, the water temperature inside the tank will approximately be 8°C lower than the

environmental temperature.

- 4.** The fan is equipped with two ice packs.

VIII. Troubleshooting guide

Malfunction	Possible reasons	Solutions
No LCD display	<ol style="list-style-type: none">1. No power or poor contact.2. Damaged screen.3. Burnt/blown fuse.4. Circuit board error.	<ol style="list-style-type: none">1. Turn power on2. Replace the screen.3. Replace blown fuse.4. Replace the circuit board
No wind or weak wind speed	<ol style="list-style-type: none">1. The fan motor is stuck.2. Filter screen is blocked.3. Main control panel error.	<ol style="list-style-type: none">1. Check the machine and the fan motor.2. Clean or replace the filter screen/cooling pad.3. Replace the wind wheel.
Motor out of control	<ol style="list-style-type: none">1. Button on the main control panel is damaged.2. The panel is damaged.	<ol style="list-style-type: none">1. Replace the main control panel.2. Replace the panel.
Drain valve leakage	<ol style="list-style-type: none">1. Drain valve damaged.	<ol style="list-style-type: none">1. Replace the drain valve.

COLENT

448-7674 / 442-3866 / 414-9890

www.colentco.com / www.colent-iwata.com