

EVAPORATIVE AIR COOLER

# INSTRUCTION MANUAL

 iwata

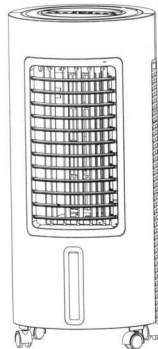

**E-COOL 16C**

CMPI

448-7674/442-3856

[www.colentco.com](http://www.colentco.com)

[email:sales\\_mktg@colentco.com](mailto:sales_mktg@colentco.com)

## Table of Contents

Product Features	2
Construction Drawing	3
Spare Part List	4
Technical Parameters	4
Operation Instruction	4
Control Panel and Operation	6
Important Safeguards	7
Maintenance and Cleaning	9
Circuit Diagram	10
Trouble Shooting	10

### Warning

This appliance is not intended for use by persons (including children) with reduced physical, sensory or mental capabilities, or lack of experience and knowledge, unless they have been given supervision or instruction concerning use of the appliance by a person responsible for their safety.  
Children should be supervised to ensure that they don't play with the appliance.

## PRODUCT FEATURES

### ● Natural Cool

It cycles the water to blow cool air. It can lower the surrounding temperature and provide you a comfortable environment in hot summer.

### ● Air Clean

Unique water honeycomb washing function effectively removes the gases like formaldehyde, ammonia which comes from the paint, adhesives and plywood of the new decorated houses. It also can filter the cigarette nicotine and freshen the air to care for your health.

### ● Ionizer

It releases negative ions to activate variety of enzymes to promote the human's metabolism and improve sleep quality. It also can be used for sterilization to freshen the air and care health.

### ● Drawer type water tank, detachable filtration mesh

Drawer type water tank design, water-tight and easy to be cleaned. Filter removes harmful tiny substances, such as dust and pollen.

### ● 60W Energy saving, high-efficiency, friendly environment

The entire input power is 60W, the power consumption is only 1/20 of that of the air conditioner.

### ● 120 angle wide range air supply function

Left and Right: 120 angle wide range air supply function

Up and Down: manual control

To make sure the airflow can be sent to every corner.

### ● Remote Control

6.5m remote control

### ● Night light function

Elegant and warm night light feature included

### ● Detachable power cord design

Power cord will be detached from the main unit if and when someone trips over the power cord of the unit.

### ● Water shortage detection

Water pump will automatically stop functioning if the level of water in the tank falls below the minimum level. This is to prolong the service life of the water pump.

## CONSTRUCTION DIAGRAM

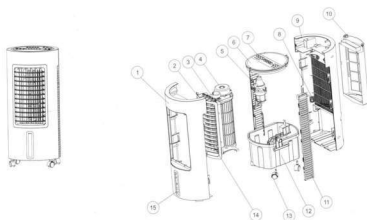

- |               |                      |                          |                     |
|---------------|----------------------|--------------------------|---------------------|
| 1 Front Cover | 5 Atomizer(Optional) | 9 Back Cover             | 13 Caster           |
| 2 Air Outlet  | 6 Control Box        | 10 Back Cover Evaporator | 14 Horizontal Blade |
| 3 Air Duct    | 7 Key Switch         | 11 Side Plate            | 15 Water Indicator  |
| 4 Motor       | 8 Power Socket       | 12 Water Tank            |                     |

## SPARE PARTS

Sequence	Accessory name	Quantity(pcs)
1	air cooler	1
2	instruction manual	1
3	warranty card	1
4	casters	4
5	power cord	1
6	Remote controller	1

## TECHNICAL PARAMETERS

MODEL	E-COOL 16C
Rated Voltage	220V
Rated Frequency	60HZ
Power	60W
Max Air Flow	650m <sup>3</sup> /h
Max Capacity	8L
Net Weight	6.0KGS
Gross Weight	7.8KGS
Product Size	310x310x700mm
Packing Size	345x345x690mm

Note: Due to constant development of our products in regards to specification and design, we take reservation for changes without prior notice.

## OPERATION INSTRUCTION

- 1.Pull the unit outwards from the carton and place it on the floor.
- 2.Check if the spare parts are complete, same as the spare parts list.
- 3.Place the unit on the floor. Take out the wheels to assemble.

Note: Two casters with brake are for the two front holes and casters without brake are for the two back holes at the bottom of the unit.

4. Follow up the direction, then add water. (Show as fig 1)

Note:

- Pay attention to the water level indicator to avoid overfilling.
- Water level must be between the MIN and MAX line.
- After some time operation, dust and dirt may occur in water tank. It is recommended to change water and clean water tank frequently.
- Water shortage alarm, when the water level is lower than "MIN" level, then the "Bi-Bi" alarm sound can be heard and the corresponding indicator light flickers, and after adding enough water to the normal water level, the light is off.
- If not adding water within 3 mins after the water shortage alarm, the water pump will stop working automatically.

5. Only use the unit with correct power required. Get the plug pin into power and a small "beep" sound can be heard and the unit is in standby state.

Note:

- Do not touch the power cord/plug with wet hands to avoid electric shock.
- Always unplug the unit when transporting it.
- Always securely plug the unit into the wall socket.

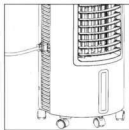

(show as fig 1)

## CONTROL PANEL AND OPERATION



(Remote controller control panel with the same function as the unit control panel)

Above for remote control model

1. **ON/OFF:** Once press this button, the power will be connected on, press again, the button will pop-up, the machine power off.
2. **KEY SWITCH:** Independent key to control SLEEP WIND, LOW WIND, MID WIND and HIGH WIND. Choose any wind key, wind wheel motor power will be connected on and start corresponding speed. Press any other wind key, the present wind key will pop up to make sure that only one wind speed is in running. Press "STOP" key, all wind speed key will pop up and wind wheel will stop working.
3. **SWING MODE:** Independent control key, press this key, the power is connected on, wind synchronous motor runs, vertical fan blades will swing in left and right, air supplies in 120 angle. Press again, the key will pop up and the wind motor will stop working.

4. **COOL:** Independent control key, press this key, pump motor will start working, pump starts pumping, evaporator starts cooling, press again, the key will pop up, and pump motor stops. is connected on, wind synchronous motor runs, vertical fan blades will swing in left and right, air supplies in 120 angle. Press again, the key will pop up and the wind motor will stop working.

5. **IONIZER:** Independent control, press button, the power will be connected on, press again, the button will pop up, ionizer will be power off and stop working.

#### 6. **WATER SHORTAGE PROTECTION OF PUMP:**

When water in the tank falls below the minimum level and the cool function is turned on or is in the on position, the pump will automatically cease to function but the fan will still continue running.

### **IMPORTANT SAFEGUARDS**

1. Do NOT open and repair the unit by any unqualified person.
2. To protect against electric shock, keep the unit dry. Do not immerse in water or any other liquid.
3. Unplug while filling water, before cleaning, maintaining or moving the unit.
4. Unplug power when not in use.
5. Do not insert any other objects into the grid of air vent (intake or outlet) during operation.
6. Do not cover the appliance with paper, cardboard, plastic, metal foil, or any other flammable material. Otherwise, a fire may occur. Keep the appliance away from any hot sources.

7. Place the unit on the ground.
8. Do not use outdoors, indoor only.
9. Water level must be between the MIN and MAX line.
10. After filling with water, do not lean the unit and avoid moving it, which may cause water to overflow the sides of the tank and leak. If the unit needs to be moved a little, push on the side gently.
11. Never put the unit side down especially with water inside, if it accidentally falls down, unplug the power immediately and don't restart until the unit is dried for at least 24 hours.
12. Do not place any liquids on the top of the unit. Do not block the air coming out from the unit.
13. Do not use petrol, or corrosive cleaner to clean the unit body. For slight dirt on the body, wipe it off with a soft damp cloth. For greasy dirt, squeeze a little toothpaste or mild detergent on a soft damp cloth, and then wipe the dirt off.
14. Keep the air vent (intake or outlet) away from obstacles such as curtains, walls and so on.
15. Do not strike or shake the unit body during operation, otherwise, it will stop working automatically. In this case, restart the unit.
16. After some time operation, dust and dirt may occur in water tank. It is recommended to change water and clean water tank frequently.
17. Do not put the unit under wall socket.
18. After stopping cool function, please keep it run for at least 1 hour to blow the honeycomb dry and avoid the mustiness.

18. Do not use if any malfunctions. Send to service center for repair.
19. Please use the attached accessories, no other programmers or devices are allowed.
20. Don't use the unit in the damp environment like bathroom, swimming pool.
21. If electric cord is broken, please replace it with the same cord from the manufacturer or the service agent.

## MAINTENANCE AND CLEANING

**Note:** After long time operation, the filtration mesh becomes clogged with dust and dirt, which will greatly affect the unit's performance. It is recommended to clean the filtration mesh frequently.

### Cleaning the filtration mesh

- 1.Pull the plug
- 2.Loose screw, catch the filtration mesh handle and pull upwards.
- 3.Clean filtration mesh with mild detergent and soft brush.
- 4.Make sure filtration mesh is completely dry before installing.

### Cleaning the water tank

1. Remove the plug power.
  2. Add water into the water tank through water inlet.
  3. Open the rubber plug at the bottom of the water tank to drain the water off.
- Wash several times.

### Cleaning the body

Clean the body with a little mild detergent on a soft cloth.

**Note:**

- Unplug from outlet before cleaning.
- No water on the control panel.

### CIRCUIT DIAGRAM

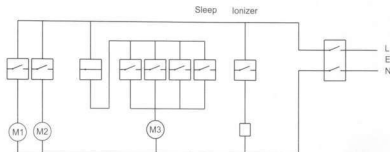

## TROUBLE SHOOTING

If there is something wrong during operation, it may not be the unit's problem. You may check against the following list before sending for repair.

Problems	Possible reasons	Solutions
Not working	<ol style="list-style-type: none"> <li>1. The plug is not securely inserted into the socket or not connected well.</li> <li>2. The "ON/OFF" button is not pressed.</li> </ol>	<ol style="list-style-type: none"> <li>1. Insert the plug pin into the wall socket and make sure it is connected well.</li> <li>2. Press "ON/OFF" button after plugged.</li> </ol>
Cool effect not good	<ol style="list-style-type: none"> <li>1. Not enough water in water tank</li> <li>2. Water pump is blocked.</li> <li>3. Air vent is blocked by dust.</li> </ol>	<ol style="list-style-type: none"> <li>1. Add water to ensure enough water for pumping</li> <li>2. Clean water tank and remove the impurities.</li> <li>3. Clean the dust or foreign objects from the air vent.</li> </ol>

**Notice:**

- 1.If the problem cannot be found in the list or it continues, please contact our service center or a qualified technician for further inspection.
- 2.Do NOT open and repair the unit by yourself.