

INSTALLING & USING OF BATTERY

LED light will flash automatically when the batteries are running out of its power. The sign for replace the batteries when the LED light flash itself. When replacing the battery, try to keep the body upright to prevent the soap in the kettle from spilling out. It will be much better if you use the standard batteries (DC 6V/AA battery (4pcs)). Do not use new battery and old one together.

So follow the directions for use:

1. Turn the power supply cover kit counterclockwise to unlock position and remove the power supply kit.
2. Insert new batteries to power supply kit in the direction of "+" and "-".
3. Push the spring on the power supply kit with the reed on the machine and press it in, press gently inward, clockwise. Rotate the screw cap to lock position, so that the clip on the power supply cover kit is caught in the card slot on the machine to complete the replacement.

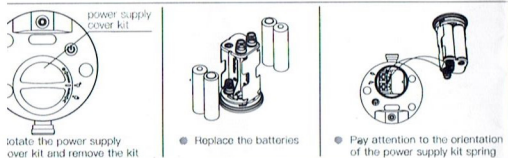

HOW TO USE

1. Turn the Sealing cap counterclockwise by hand and open. After putting into liquid soap. The surface of the unit should be cleaned if there is liquid soap flows the container.
 2. After the power supply kit cover, remove the power supply kit, and load the batteries (DC 6V/AA battery (4pcs)) and put it back, long press the setting button for about 2 seconds, then the LED light on with a flashing, after 3 times flashing will the unit stay in standby. Long press the setting button for about 2 seconds, with a flashing after 3 times flashing will the unit stay in standby, long press the setting button switch between turning the machine on and off.
 3. Following the LED light direction the liquid soap will spray out automatically when you stretch out your hands under the flash sensor reception window.
 4. Reach the standard may you have recurrent operations on point 4.
- The sign for replace the batteries when the LED light flash itself 3 times in 30 seconds. Once the batteries running out of its power change the whole battery for brand-new one.

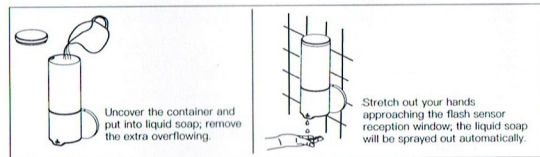

HOW TO MAKE A SETTING

- After the unit is loaded with the battery, long press the setting button for about 2 seconds, then the LED light on with a flashing, after 3 times flashing will the unit stay in standby, the liquid soap supply of the unit is the original default setting.
- Adjustable liquid soap supply: At the standby status this unit can be set to different 3 level of liquid soap supply. The volume of liquid soap supply can be changed through slightly pressing the setting button. According to the testing result (using liquid water as object) that the original default is around 0.9ml. Press the setting button changed the original default to level 2 (about 2.0ml), Indicator light flashes twice, then level 3 (about 3.1 ml), Indicator light flashes 3 times. This loop program can be easily controlled by users or managers.

SIMPLE TROUBLESHOOTING ACTIVITIES

Situation	Causes	Method
LED light doesn't work	Control system trouble	Replace control system
	Power supply problem	Check circuit or battery
	Batteries loose or run out of power	Reload or change new batteries
	Poor contact inner power cable	Recheck inner power cable
	Dirty sensor window	Clean sensor window immediately
LED light flash frequently	Less power supply	Recharge or change batteries (DC 6V/AA battery (4pcs))
No liquid soap supply	On-going sensor reception	Remove reflective object
	Long sensing distance	Insert hands or slowly move hands up & down
	Unqualified machine	Contact regional dealer or contractor
Less liquid soap supply	Supply liquid soap within short time	Make an adjustment in the manner intended by manufacturer
	Extremely dense liquid	Refill Low dense liquid
	Blocked pipe	Try again or contact qualified person

Note: No impurities and other dirt in inner storage of this unit.

MAINTENANCE & WARRANTY

1. The maintenance is for free charge within 1 year (from the date of invoice).
2. The range of maintenance is exclusive of normal depreciation or any damages caused by improperly using.
3. It's not in the range of maintenance when the unit was fixed and repacked by user or was damaged in operation with unoriginal objects.
4. The manufacturer will take the responsibilities for own products. If the unit is out of warranty, the manufacturer charges only the cost of material in principle and delivers the original objects to the users.
5. There are other situations for repair but charge the cost also:
 - A. Include risks of fire, earthquake, flood and other forces of nature.
 - B. Be damaged by improperly installation & program debugging or connect the power supply kit into improper terminal block location.
 - C. Improper using & maintenance or using in seriously bad environment caused problems of this unit.
 - D. Damages are caused by wrongly move and refit or repaired by unqualified person.
 - E. Liquid soap supply kit is blocked by gelatinous precipitation or other objects.
 - F. No warranty card or warranty card has lost the rights.
6. By keeping the warranty card and other certifications can make sure the rights of you for free services. All information needs to be provided to the dealer or contractor when you repair this unit.



CM21SD-5

USER MANUAL

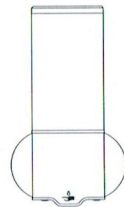

For after-sales service:
 Website: www.colentco.com
 Landline: (02)8282-5098; (02)8282-5049
 (02)8442-3866; Local 502 & 503
 Mobile :
 Smart - 09088908597
 Globe - 09173079188
 Email: sales_mktg@colentco.com ,
 iwata@colentco.com ,
 iwata2@colentco.com ,
 iwata3@colentco.com

CAUTION & IMPORTANT SAFETY INSTRUCTIONS



CAUTION:

1. Do not delivery heavy strength on this unit because there are small components and solenoid valves as inner structure.
2. All surfaces of this unit should be cleaned with a soft cloth and a noncaustic cleaning solution. Then wipe extra cleaning solution & dirt out with wet cloth, and then dry the unit with soft cloth. Do not clean this unit by showering or using nonstandard cleaning solutions. To keep this unit working in best condition please don't do anything that will do harm to the sensor window.



READ AND KEEP THESE INSTRUCTIONS SAFETY PRECAUTIONS

WARNING--TO REDUCE THE RISK OF INJURE TO PERSONS OBSERVE THE FOLLOWING.

- This appliance is not intended for use by children (to protect them from eating liquid soap), unless they have been guided by a person who is responsible for their safety.
- To protect the environment please make sure the exhausted battery is disposed in an environmental friendly and healthy way. By collecting and recycling waste, this exhausted battery has to be disposed at an authorized place.



TO MAKE SURE THE APPLIANCE DO WORK AND EXTEND ITS LIFESPAN UNDER THE GOOD CONDITION, PLEASE NOTICE THAT:

1. The instructions must be followed carefully when installing this unit.
2. Using the same AA battery (4pcs) of well-known brand. If the power supply doesn't work well, it may do harm to the unit and make short lifetime of this appliance.
3. When installing into wall, do check the wall is flat or not, cleans the surface of wall at the same time.
4. Distance (more than 25cm) will be needed from the bottom of unit to tables or other objects.
5. The instructions of installation will be given to the user or manager by qualified person.
6. Reflective objects must not be put in the sensing distance under the unit.
7. Don't cover with reflective objects on the table against the bottom of this unit. If the unit stops or works strangely please check it around and make sure there are reflective objects (such as mirror, stainless steel or other things) be wrongly placed.
8. Indoor use only, do not use outdoor.

SPECIFICATIONS

Voltage	DC6V/ AA Battery (4pcs)	Supply	0.9m/2.0m/3.1m
Volume	500ml/500mlx2/500mlx3	Sensing distance	5-9cm
Ambient temperature	0-45°C	Protection class	IPX7
Appearance size	128x91x223mm	NW	0.5kg
	181x91x223mm(two-combination)	(Without battery)	0.9kg
	282x91x223mm(three-combination)		1.3kg

Note: The liquid output was measured with water as liquid under dry battery 5V condition. For reference only.



SERVICE TIPS:

- Please make sure the following items are included with your automatic dispenser when you open it the first time. If any items are missing or if there are any problems about the objects, contact your regional dealer or contractor.
- Any specification of the items changed might be not informed in time. If there are any difficulties in installation, please contact your regional dealer or contractor.
- Main objects are sealed by special bag. Don't hit or drag too heavy when you move or open the bags.

SPARE PARTS

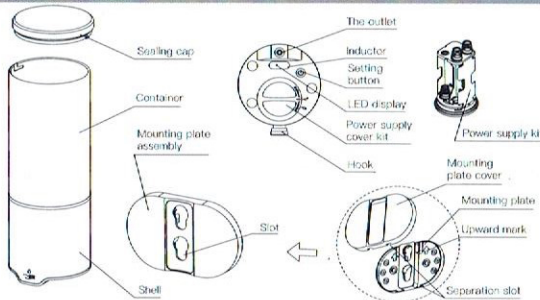

PACKING LIST

Automatic soap dispenser X1	ST4X25 screws kit X2 (Remarks: 3(three-combination))
Mounting plate assembly X1	Plastic nail-head X2 (Remarks: 3(three-combination))
Certification X1	Manual X1

SKETCH MAP OF INSTALLATION

Reference distance

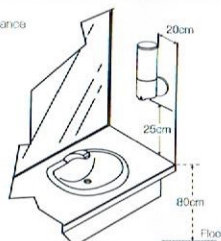

Caution: If the surface of table is made of stainless steel, the sensing distance must be over 35cm.

INSTALLATION STEPS

1. Wall mount kit shall be put in the manner intended by manufacturer. Use a flat-blade screwdriver on the separation slot of the mounting plate assembly. Let's separate the mounting plate assembly. Use pencil to mark the position of the hole.

Note: When the two-combination and threecombination installations can be installed directly, there is no need to separate the cover and the mounting plate, and the remaining installation methods are basically the same.

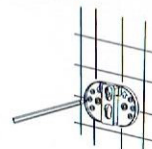

2. Use a drill to bore two holes (Φ6) in the wall according to the marks. Put plastic Expansion pipe into the corresponding holes.

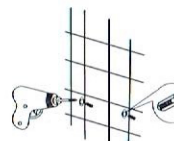

3. Align the mounting holes on the mounting base plate with the previously installed Expansion pipe, paying attention to the upward direction and fixed the mounting base plate to the wall with screw.

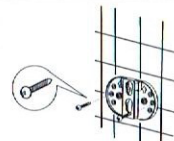

4. Snap the cover to the mounting base plate, pay attention the direction of separation slot.

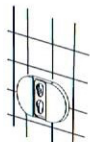

5. Align the hook on the soap dispenser with the large holes in the slot on the mounting plate assembly. Insert it and press it down. When you hear a click, gently shake the machine. The machine does not shake, indicating that the machine is stuck.

