

## CLEANING

WARNING: Please cut off the power supply before maintenance.

- 1: When machine has grease, must clear clean, lest cause discoloration, damage
- 2: After maintenance and cleaning, pack each part into the packing box according to the original packing order and place it in a dry place for proper storage
- 3: The machine only needs general external cleaning and maintenance
- 4: Use neutral cleaner to wipe, reoccupy clean and soft cloth is wiped clean
- 5: Do not rinse directly with water
- 6: Avoid using thinner, toluene, acid lotion, oil and other wipe, so as to avoid discoloration or deterioration

## MALFUNCTION AND MAINTENANCE

Malfunction	Causes	Solution
Can not boot up	1. The power cord is not plugged in 2. The switch knob is not turning	1. Plug in to ensure good contact 2. Turn the switch knob to open
Can not shut down	The switch knob is not turning	Turn the switch knob to shut down
Noise	The air inlet is blocked with debris	Remove the foreign body after power off
Sudden shutdown	1. The air outlet is blocked 2. More than the timer	1. Remove the foreign body after power off 2. Re-timed
Drying time is too long	The dry matter is too thick	Use after dehydration

### INTRODUCTION

- Thank you for purchasing our clothes dryer.
- Each unit has been manufactured to ensure safety and reliability.
- Before first use, read the instructions carefully and keep it for further reference.

For after-sales service:

Landline-(632)442-3866;412-6155;413-8819;442-3856;448-7674  
Mobile-0923-5345681;0917-3079188;0920-9746874  
Email at sales\_mktg@colentco.com , iwata@colentco.com ,  
iwata2@colentco.com , iwata3@colentco.com  
Web: www.colentco.com

# CLOTHES DRYER

MODEL: CM20CD-9



(Please read these instructions carefully before using for first time. Keep these instructions safe for your future reference..)

## CAUTION

- 1.Warning - appliances should only be used for dry washing fabrics
- 2.Before the first use, please check whether the voltage you use is consistent with the requirements of the product nameplate
- 3.If the power cord is damaged, it must be replaced by a professional from the manufacturer, its maintenance department or similar department to avoid danger
- 4.If there is a stain on the surface of the clothes dryer, wipe it with soft cloth and soap. Do not use gasoline, alcohol and other organic solvents.
- 5.Do not use in high temperature, humidity, dust, acid and alkali oil and other volatile places
- 6.Please dry or dehydrate the clothes before putting them in the dryer to dry
- 7.This product is strictly prohibited to be used in the environment with inflammable and explosive materials, and the ambient temperature should not exceed 30° and be at least 50CM away from combustible materials to prevent fire
- 8.Make sure appliances are disconnected when blackout or moving
- 9.Do not touch the hot air outlet when using to avoid scalding
- 10.Warning: to avoid overheating, do not cover the heating body
- 11.Please check whether the power cord and plug are damaged before use
- 12.Do not bend or pull the power cord to avoid bad contact
- 13.When leaving or not in use for a long time, be sure to disconnect the power and pull out the plug
- 14.The fire protection cover of the heating body is used to prevent direct contact with heating elements. When the heater is in use, the fire protection cover must be installed in place. Fire shields do not provide comprehensive protection for children and the disabled
- 15.When used as a portable appliance, this appliance shall not be used around the fish tank, sprinkler head or swimming pool
- 16.Turn off the power before pulling out the plug. Do not pull the power cord
- 17.Do not pull out the power plug with wet hands, there is a danger of electric shock
- 18.Heater should not be placed directly under the power outlet
- 19.Never insert hands or foreign bodies into the body during work, which may cause injury or damage. Children should pay special attention
- 20.Children should be supervised to ensure that they do not play with utensils
- 21.This appliance is not intended to be physical and mental defective, or the lack of experience and common sense of people (including children) to use, unless they are their security director give enough care and guide how to use the tools.
- 22.This appliance should not be used in the curtain or other places that are easy to be sucked in. It should avoid the surrounding obstacles and unstable places.

## PERFORMANCE PARAMETERS

Model	Rating Power	Power	Waterproof level	Anti-shock level
CM20CD-9	220V~60Hz	900W	IPX1	II

## Part name

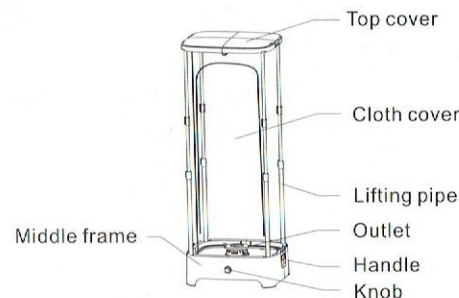

## ASSEMBLING AND WATERING

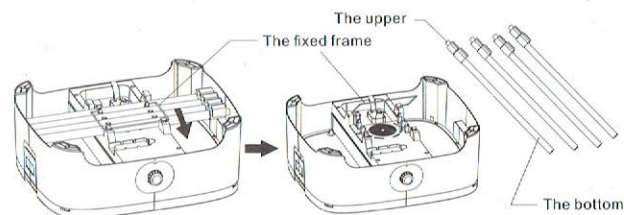

- 1.Take out the product and flip it to the back, push out the fixing frame forward and turn it up, then take out the lifting tube Set aside and install the fixture in place.

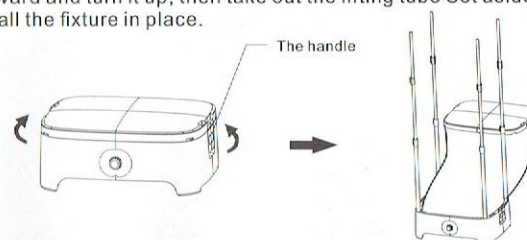

- 1.Lift the handle up, open the top cover, then lengthen the lifting tube, lock and fix it, insert the lower end of the lifting tube into the four hole positions in the middle frame, and insert to the bottom.

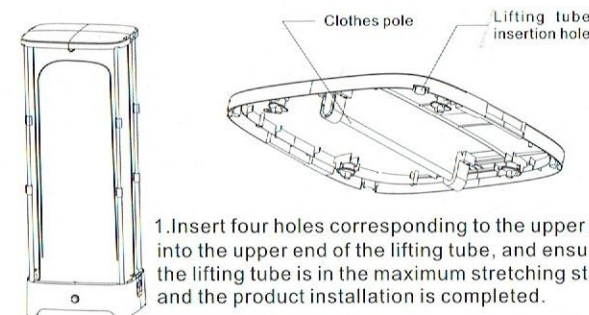

- 1.Insert four holes corresponding to the upper cover into the upper end of the lifting tube, and ensure that the lifting tube is in the maximum stretching state, and the product installation is completed.

## OPERATION

- 1.Put the power plug into the power socket.
- 2.Rotate the timing knob and the machine will enter the normal working state.
- 3.Clockwise rotate the switch to start the machine and select the timing time.
- 4.This product can be timed for 0-180 minutes.
- 5."off" position is shutdown.
- 6.Counterclockwise rotate the switch knob to "on" for unlimited time.

## ADVANTAGE

- IEasy installation, can be installed quickly.
- IReceive simple and easy, integral style receives,
- can put everywhere.
- IAutomatic cut-off.
- IHidden outlet design.