

INSTALLATION INSTRUCTIONS

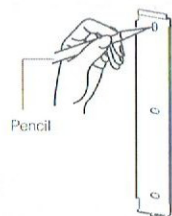

1. Refer to step 5, remove the mounting plate from the machine. Attach the mounting plate to the wall and draw the positions of three mounting holes with pencil.

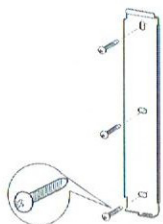

3. Align the mounting holes on the mounting plate with the plastic expansion on the wall, and fix the mounting plate on the wall with screws.

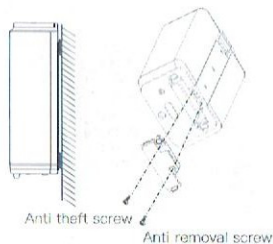

5. Screw on the anti-theft screw, then install the battery box and screw on the anti-removal screw. Lower clips snap in.

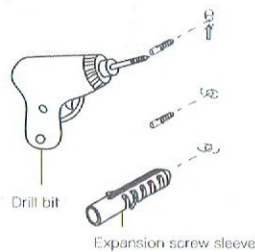

2. Drill three holes of 6mm, and insert the plastic expansion into the drilled hole.

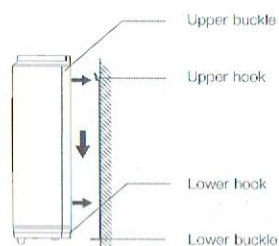

4. Align the groove on the machine with the hook of the mounting board, and then make the machine fit the mounting board, and then slide the machine down to make all the upper and lower clips snap in.



CAUTION

1. There are precise electronic devices and solenoid valves in this product. Do not knock them to avoid failure.
2. Take care not to damage the connecting wire when disassembling the product.
3. When the product needs to be cleaned, please dip the soft cloth in the neutral detergent and brush it. Then wipe off the detergent and dirt with a wring dry wet soft cloth, and then dry with a dry soft cloth. Do not wash the product with water or with detergent containing particles, diluent, detergent with strong acid and nylon brush so as to avoid damaging the appearance or eroding the internal electronic components. Pay special attention not to damage the transparent cover at the sensing window, so as to avoid poor sensing effect.

iwata

Automatic Soap Dispenser

CM21SD-4

USER MANUAL

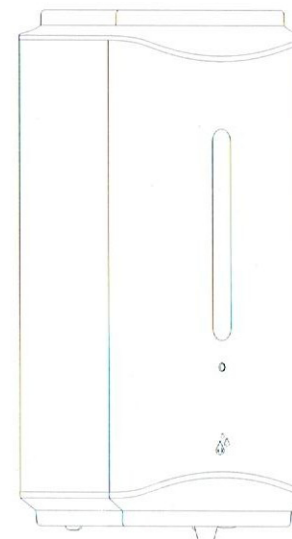

For after-sales service:

Website: www.colentco.com
 Landline: (02)8282-5098; (02)8282-5049
 (02)8442-3866; Local 502 & 503
 Mobile :
 Smart - 09088908597
 Globe - 09173079188
 Email: sales_mktg@colentco.com,
iwata@colentco.com,
iwata2@colentco.com,
iwata3@colentco.com

PRODUCT INTRODUCTION

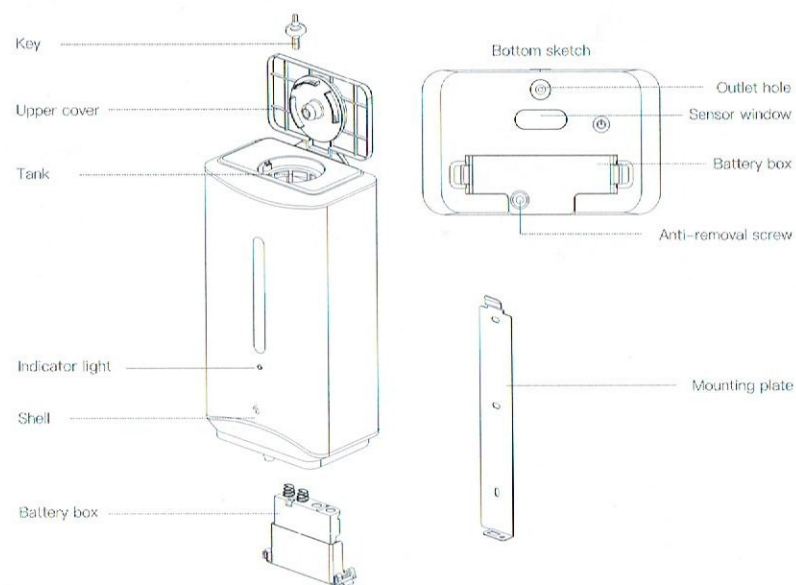

Note: the actual object shall prevail

PRODUCT DIMENSION DRAWING

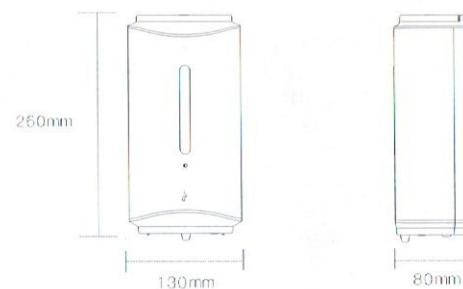

INSTALLATION DIAGRAM

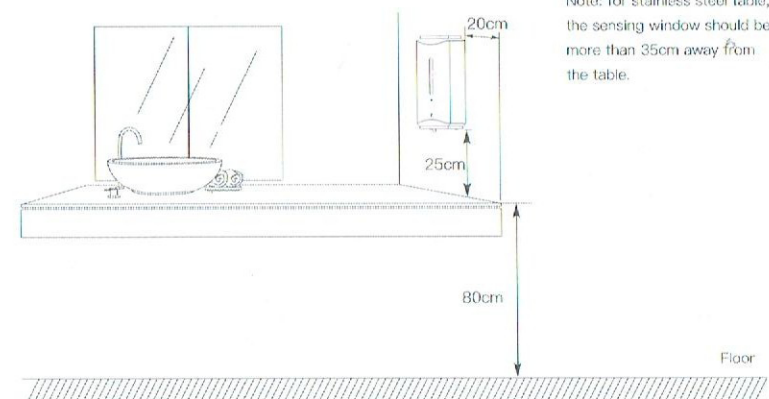

MATTERS NEEDING ATTENTION

In order to ensure that this product can fully play its unique function well in the future work and extend its service life, please pay attention to the following points:

1. Before design and construction, please carefully read the product operation manual and installation instructions
2. The batteries used must have 4 AA batteries with good reputation and quality. The battery brand must be consistent, and the old and new batteries cannot be mixed. If a fake or low-grade battery is used, it will affect the operation and service life of the machine
3. When installing the product, first check whether the wall is flat and wipe the wall clean
4. The lower part of the sensor must be more than 25cm away from the reflector or the table top
5. After installation, please hand over the manual to the manager or user
6. Do not place obstacles within the sensing range
7. Please do not inlay stainless steel and other reflective items or install similar photoelectric sensors on the counter directly opposite the induction window. To avoid misoperation
8. Please do not install it in the place directly exposed to the sun to avoid misoperation
9. If alcohol is used, keep away from open flames

PACKING LIST

Unit X1	Installation Panel X1	ST4X25 Screw X3	Installation Manual X1
Expansion Screw X3	Certification X1	Key X1	

1. Before the first unpacking and installation, if there is any discrepancy with the packing list, please contact the local dealer or manufacturer in time
2. Specifications of some accessories are subject to change without notice. Please contact the dealer or manufacturer in time for any problems that cannot be solved during installation
3. The main parts are sealed in special bags. Please do not collide or rub excessively when handling or unpacking to avoid damage.

INSTALLATION AND REPLACEMENT OF BATTERY

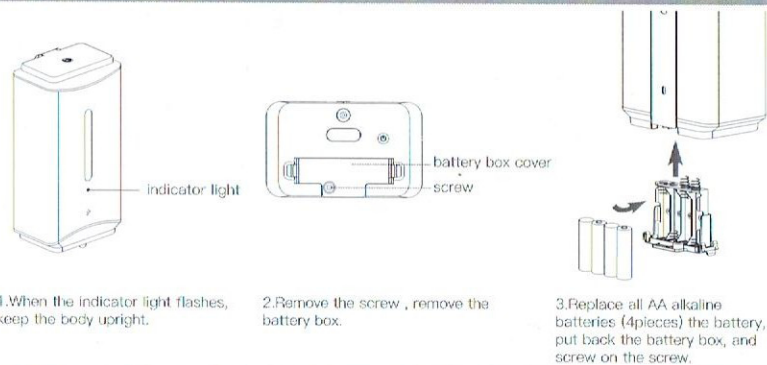

METHOD OF USE

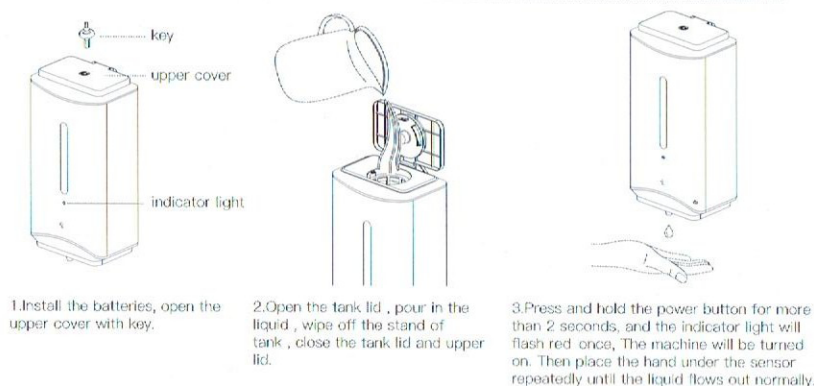

- After batteries are installed, long press the power button for more than 2 seconds, and the indicator light will flash once, and the machine will be turned on. If you press the power button for a long time, you can switch between starting and sleeping.
- The machine is best equipped with batteries before it is used, so that the machine will automatically run once every half a month to prevent the catheter from being compressed and sticking.
- Some machines are equipped with batteries when they leave the factory, and the machine is factory-set in sleep mode. Please press and hold the power button for more than 2 seconds before using. The indicator light flashes once and the machine enters the standby state. On the contrary, if you press the power button for more than 2 seconds, after the indicator light flashes once, the machine enters the sleep state.
- Low battery reminder, when the indicator light flashes red three times every 30 seconds, the batteries need to be replaced.



- Minors should be accompanied by their guardians to use the product, so as to prevent minors from eating soap by mistake!
- In order to protect the environment, please do not discard the batteries that have been exhausted and replaced at will. Please collect the used batteries according to the specified recycling method!
- This machine contains a microcomputer and other precise electronic circuits. It is strictly forbidden to shower!

ADJUSTMENT OF LIQUID SOAP SUPPLY

When the machine is in standby state, liquid output can be adjusted by pressing the liquid adjusting key. The default gear of the machine is gear 2(1ml). In standby mode, after pressing down the liquid adjustment key for the first time, the indicator light flashes three times, the gear is switched to gear 3(1.5ml); the second time, the indicator light flashes four times, the gear is switched to gear 4(2ml); for the third time, the indicator light flashes for five times, and the gear is switched to gear 5(2.5ml); for the fourth time, the indicator light flashes for one time, the gear is switched to gear 1(0.5ml) and adjust the gear in this circle.



SIMPLE TROUBLESHOOTING TABLE

Phenomenon	Cause of trouble	Treatment
Light does not shine	Controller failure	Replace controller
	Power supply is abnormal	Please check the circuit or battery
	The battery is poorly connected or the battery is empty.	Reinstall the battery or replace the battery
	Internal wiring disconnected or poor contact	Recheck internal wiring
Indicator flashes	The sensor window is too dirty	Clean the sensor window
	The battery is low.	Replace the battery (4 simultaneous replacements)
The indication is normal but liquid cannot be discharged	The sensor continues to sense	Remove possible sensors
	Sensing distance is too long	Adjust the position of the hand
	Machine malfunction	Please inform the dealer
Insufficient liquid output	Liquid discharging time is too short.	Please refer to the instruction manual for the adjustment of the feeding quantity
	The liquid is too viscous	Please replace it with a liquid with low viscosity
	Liquid solidification or blockage	Please use it continuously until the liquid can be ejected normally or contact the dealer

Note: Avoid sundries in the kettle to avoid blocking

TECHNICAL PARAMETER

Volume	1100ml	Power	4 AA alkaline batteries
Dimension	130x80x260mm	Inducting distance	5-9cm
Net weight	1.1kg	Liquid supply	0.5ml/1.0ml/1.5ml/2.0ml/2.5ml

Note: The liquid output was measured with water as liquid under dry battery 5V condition. For reference only.