

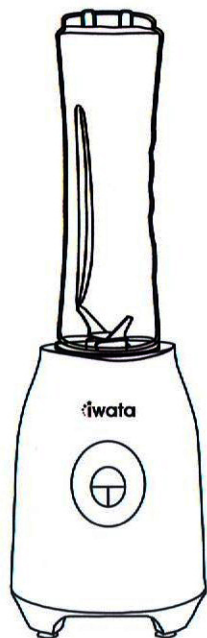

Model: PRO-BLEND MINI  
PERSONAL BLENDER



Exclusively distributed by:

COLENT MARKETING PHILIPPINES, INC.

Berton's Place, #46 Sta. Rosa Street, Quezon City, Philippines 1115

Website: [www.colentco.com](http://www.colentco.com)

Landlines: 8282-5049; 8282-5098

Mobile: 0923-5345681; 0917-3079188; 0920-9746874

Email: [sales\\_mktg@colentco.com](mailto:sales_mktg@colentco.com), [iwata@colentco.com](mailto:iwata@colentco.com),  
[iwata2@colentco.com](mailto:iwata2@colentco.com) or [iwata3@colentco.com](mailto:iwata3@colentco.com)

LEARN MORE



## READ THIS MANUAL THOROUGHLY PRIOR TO INITIAL USE AND SAVE FOR FUTURE REFERENCE

### SAFETY PRECAUTIONS

Check that the local voltage supply matches the rated voltage of product.

1. Do not allow the power cord and plug to come in contact with water or other liquids to avoid electric shock or fire.
2. Do not allow children and persons with reduced physical and mental abilities to operate the blender without any adult supervision.
3. Unplug the unit before changing accessories or cleaning and make sure the motor is turned off when removing the pitcher from the base.
4. The product and its power cord should be properly and safely stored to avoid accidents.
5. Do not use the appliance if power cable or plug is broken or defective. Please contact the distributor/customer service for repairs.
6. Please position the blender on a desk or flat place when using.
7. Please do not use this blender under such situations: high temperature, near inflammable gas or an electric stove & etc.
8. Do not touch any part of the blade when unit is turned on.
9. The blades are very sharp. Please be careful when assembling or cleaning it to avoid injuries.
10. Do not use unauthorized attachment/s with the blender. The use of

attachments that are not recommended by the manufacturer can result in injury or damages and will void warranty on the unit.

11. Do not immerse the pitcher in water or other liquid when cleaning.

12. Make sure the pitcher is properly mounted to de-activate the safety switch.

## PRODUCT SPECIFICATIONS

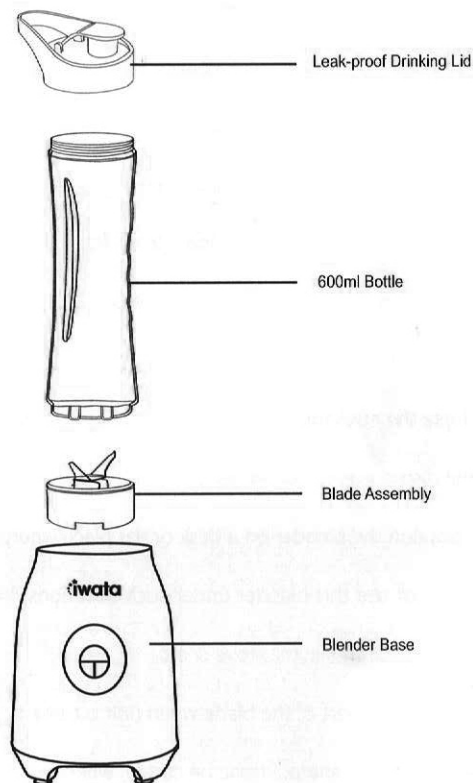

| Item No.:      | Rated Voltage | Frequency | Power | Capacity | Rated speed |
|----------------|---------------|-----------|-------|----------|-------------|
| PRO-BLEND MINI | 220V-240V     | 60HZ      | 300W  | 0.6L     | 20000RPM    |

## OPERATIONAL GUIDELINES:

1. Place the sport bottle on a flat surface with the open end facing up. Fill the sport bottle with your favourite ingredients in liquid. Be sure not to fill ingredients exceed the Max. marking line.



2. Fasten the blade assembly on the open end of the sport bottle.

Turn the sport bottle upside down, line up arrows on the blade assembly to the arrows on the base, and place the sport bottle at the base.

For hands-free operation, please align the safety switch on the blade holder with the safety opening on the motor base and turn the sport bottle clockwise in the base. If the bottle is not locked on the right position, the button will not work.

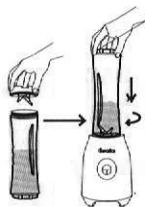

Pressing the button on the housing to switch on the blender. Blender will stop working once stopping pressing.

3. Turn the sport bottle over and place it on a flat surface. Replace the blade assembly with the drinking lid. Take the Sport bottle with you throughout the day to stay hydrated.

