



INSTRUCTION MANUAL

Evaporative Air Cooler



AIRBLASTER 28

PLEASE READ THESE INSTRUCTIONS BEFORE USE.

FOR PRODUCT PURCHASE:



Berton's Place #46 Sta. Rosa St. Barangay Manresa Quezon City, Philippines.
Tel Nos. 8442-3856; 8442-3866; 3448-7674; 3412-6155; 3413-9503; 8282-5049; 8282-5098
Email: iwata@colentco.com, iwata2@colentco.com, Website: www.colentco.com
iwata3@colentco.com, sales_mktg@colentco.com



Suite 300 Del Monte Mansion Building Del Monte Avenue corner
210 Speaker Perez St., Quezon City, Philippines
Tel Nos: 8742-8139 / 8742-8140 / 8742-1526 / 8740-3815
Mobile No.: 0917-5413633 Email: diversifiedcolentcdpi@gmail.com
Website: www.colent-iwata.com

FOR AFTER SALES SERVICE:



HELP SQUAD SERVICES, INC.
297 D. Tuazon Ave., Brgy. San Jose, Quezon City
Phone Nos.: 0908-8908597 (Smart) / 0917-1042611 (Globe) 0917-1082201 (Globe)
Email: helpsquadservices@gmail.com / sales_mktg@colentco.com

iwata

INSTRUCTION MANUAL

Evaporative Air Cooler



AIRBLASTER 28

BEFORE USING THE UNIT

1. Precautions

- ✧ Avoid using the evaporative cooling fan in a closed space. The unit should be used in well-ventilated areas only.
- ✧ Voltage should be monitored to make sure that it is within $\pm 5\%$ range. If the voltage is too low, the cooler may not turn on or may be on and off. Too low or too high voltage may cause damages to the cooler.
- ✧ User manual, qualified certificate, remote control, warranty card, etc. are attached for specific models.

Before turning the unit on, fill the tank with clean water to ensure efficient operation of the evaporative air cooler.

Avoid operating Cool function while the water tank is

empty. Remarks: Do not put any other liquid into the tank.

Water level must not exceed the limit of water level scale

2. Operating Instructions and Functions

2.1 For Control Panel and Remote Control

Control Panel

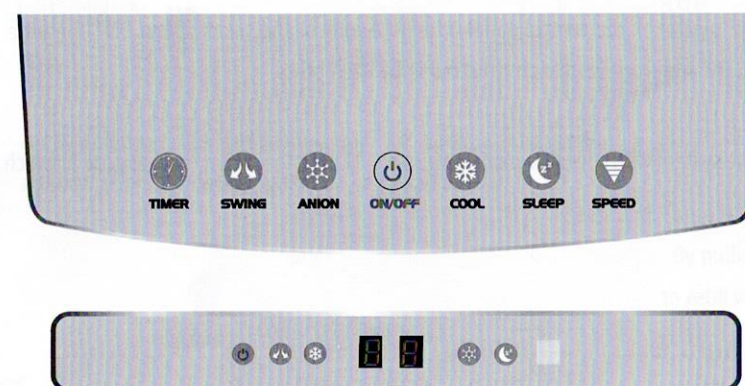

Remote Control

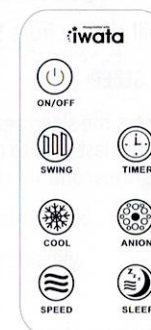

❖ Start up/Air Circulation

When the air cooler is switched on, it is on standby mode with a beep. After pressing the "ON/OFF" button, the air cooler will start operating in a low air circulation speed or "Level 1 (low)". Press the "Speed" button on the control panel or remote control if you want to change speeds. There are nine speeds, including Level 1 (low), To 9 (strong). The air speed levels will work on a rotating cycle. When the power is on, the indicator light is on and keep pressing the "ON/OFF" button to turn off the light. The indicator light can be on again by pressing any button.

❖ Cool

Enter the Cool mode by pressing the "Cool" button on the control panel or remote control. To turn off the Cool mode, press "Cool" again. The system will automatically exit the Cool mode. When the Cool mode is on and the indicator light of "Cool" button keeps flashing, it means the water tank need to be refilled. In the case where the wind speed is high, when the "Cool" button is pressed, the cooler will drop to the lowest speed for 80 seconds before resuming the speed previously set. The indicator light of water shortage stop pump flashes 3 times, and the buzzer rings 3 times.

❖ Swing

Press the "Swing" button on the control panel or remote control to have the vertical louvers swing automatically and the unit will enter the Swing mode with indicator light on. Press again and the louvers will stop swinging with indicator light off.

❖ Anion (optional component)

Enter the Anion mode by pressing the "Anion" button on the control panel or remote control with indicator light on. Press again to exit the Anion mode with indicator light off.

❖ Timer

Press down the "Timer" button on the control panel or remote control and select "Time ON", the time will change from 1H to 9H and from 9H to non-time mode by each press.

❖ SLEEP

Press the sleep gear. The system will move down one gear every 30 minutes until it reaches gear 1, which is the last gear to run.

2.2 Cleaning and Maintain for Cooling pad

In order to ensure cooling effect, the cooling pads should be cleaned regularly (once every 4-6 months). When cleaning cooling pads, the hydraulic pressure can not be too high and the temperature should not be more than 40 degrees centigrade. It is recommended that using soft brush to wipe off the dust on the cooling pad. After cleaning, the cooling pads should be dried off and put back to cooler. If the cooler does not work for a long time, in order to avoid damaging the cooler due to humid weather conditions and to avoid breeding mosquitoes and other insects, the water tank should be drained and turn on the cooler by pressing "ON/OFF" button to dry off the cooling pads. Shut off the cooler after cooling pads are dried off.

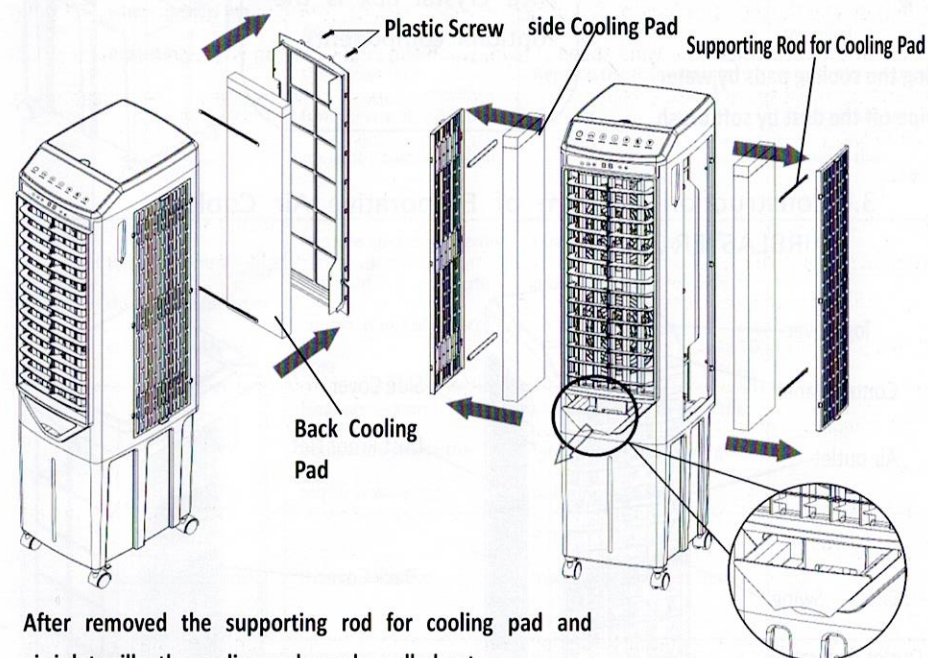

There is a hole for uncovering
By pulling out upward
to refill water steadily.

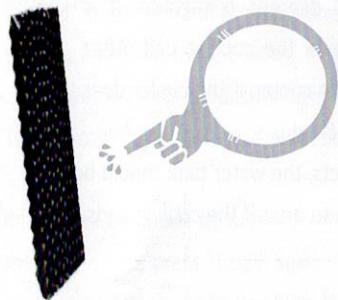

Cleaning the cooling pads by water and wipe off the dust by soft brush.

Put the ice crystal box and take it out with the power off. Do not refill the water tank from here.
(ice crystal box is the optional component)

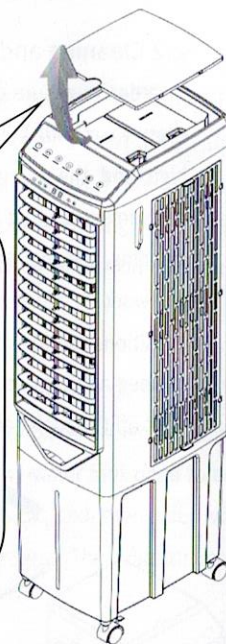

3. Construction Diagram of Evaporative Air Cooler AIRBLASTER 28

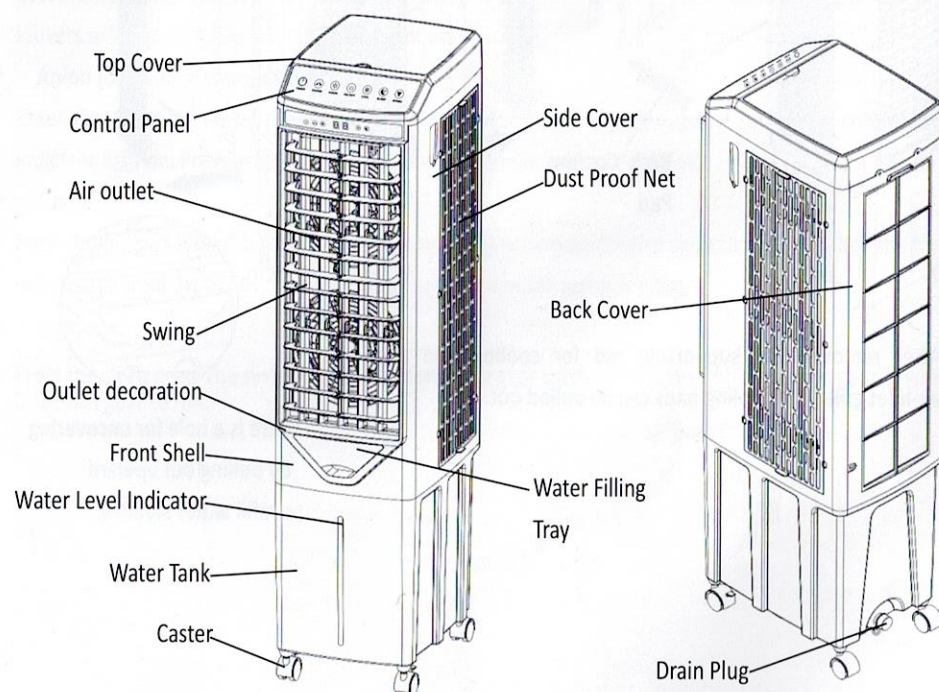

4. Troubleshooting Guide

| AIRBLASTER 28 | | | | |
|---------------|--|---|--|--|
| No. | Problem | Possible Cause | Corrective Action | Remarks |
| 1 | The evaporative air cooler is not functioning and does not respond when buttons are pressed. | Blackout or faulty power connection | Measure the input voltage and connect to a designated power supply. | We recommend that a voltmeter is used because an electrician's screwdriver cannot correctly measure voltage. |
| | | AC fuse is damaged or the circuit stops functioning in order to prevent power overload. | Replace the fuse or restart the unit. | Restart the power overload prevention system and find out the cause of the overload. |
| 2 | Remote control does not respond or is less responsive. | Remote control batteries have run out or remote control is out of control area. | Change the batteries and use remote control with control area. | |
| 3 | No air flows from the unit after the "On/Speed" button is pressed. | Heat protection equipment inside the motor is working. | Leave the unit off until the fan motor is cool enough to be used as usual. | |
| | | Damaged motor | Repair or replace the motor with another of the same model. | |
| | | Loose motor connection | Determine whether or not the motor connections are in order. | |
| | | Damaged heat relay | Repair or replace the control panel with another of the same model. | |

| | | | | |
|---|---|--|--|--|
| 4 | The pump functions but it is not cool enough. | Air ventilation chamber is not large enough. Filter pads are clogged or dirty. | Clean or replace the filters. | Check the parameters of the replacement parts. |
| | | The filter pads are dry or contain insufficient water while the air cooler is working. | Check the water distribution system to determine whether or not there is a clog. Determine if the pump is functioning correctly. | |
| | | Excessively high relative humidity | When the cooler is used for a prolonged of time, the room humidity will be very high, so the cooler will be unable to lower temperatures as much as when the room's humidity is lower. Turn the pump off and increase ventilation. | |
| 5 | The pump fails to function and provide cooling | Damaged pump | Repair or replace the pump with a pump of the same model. | |
| | | Loose motor connection | Tighten connection | |
| 6 | The pump functions but does not circulate water, or the filter pads contain too little water. | Clogged or dirty strainer | Clean the strainer. | |
| | | Clogged water supply hose | Clean the hose. | |
| | | Clogged drain | Clean the drain. | |
| 7 | Undesirable odor | The unit is placed in an area where undesirable odors are present, or algae are present in the water tank. | Clean the cooling machine. | |
| 8 | White sediments in the water tank | Water has a high content of salt | Drain the tank more frequently. | |

5. Product Dimension

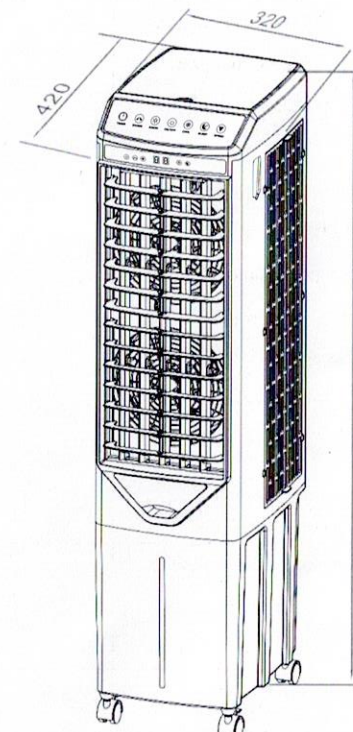

6. Technical Information

| | |
|--------------------|--------------------------|
| Model No. | AIRBLASTER 28 |
| Air Volume | 4000m ³ /h |
| Voltage | 230V~ |
| Frequency | 60 Hz |
| Power | 80 watts |
| Tank Capacity | 32 Ltrs |
| Dimensions | (L)420x(W)320x(H)1220 mm |
| No. of Cooling pad | 3 PCS |
| Area Coverage | 30 m ² |